



**exp.** Services Inc.  
*The new identity of*  
**Advanced Environmental**  
15701 Robin's Hill Road,  
Unit 2 London, ON N5V 0A5

---

**DESIGNATED SUBSTANCES SURVEY**

**REASSESSMENT 2012**

**St. Peter Canisius School**  
**Watford, Ontario**

Prepared for:

St. Clair Catholic District School Board  
245 Tecumseh Street  
Sarnia, Ontario  
N7T 2L1

March 15, 2013

Project No.: 12-5738

## TABLE OF CONTENTS

<b>1.0</b>	<b>INTRODUCTION .....</b>	<b>1</b>
<b>2.0</b>	<b>SURVEY METHODOLOGY.....</b>	<b>1</b>
2.1	ASBESTOS .....	2
2.2	OTHER HAZARDOUS BUILDING MATERIALS AND DESIGNATED SUBSTANCES .....	2
<b>3.0</b>	<b>REGULATORY REQUIREMENTS.....</b>	<b>2</b>
<b>4.0</b>	<b>RESULTS.....</b>	<b>3</b>
4.1	ASBESTOS-CONTAINING MATERIALS.....	3
4.2	LEAD.....	5
4.3	MERCURY .....	5
4.4	SILICA .....	5
4.5	ACRYLONITRILE, BENZENE, ISOCYANATES, ARSENIC, ETHYLENE OXIDE, VINYL CHLORIDE AND COKE OVEN EMISSIONS .....	5
4.6	MOULD .....	5
<b>5.0</b>	<b>RECOMMENDATIONS .....</b>	<b>6</b>
5.1	ASBESTOS .....	6
5.2	LEAD.....	7
5.3	MERCURY .....	7
5.4	SILICA .....	8
5.5	MOULD .....	8
<b>6.0</b>	<b>LIMITATIONS AND WARRANTY.....</b>	<b>9</b>

## APPENDICES

APPENDIX I	ASBESTOS BULK LABORATORY RESULTS (From Previous Assessments)
APPENDIX II	UPDATED ROOM-BY-ROOM ASBESTOS MATERIALS SUMMARY
APPENDIX III	DRAWINGS

## 1.0 INTRODUCTION

Exp Services Inc. (exp) was retained by the St. Clair Catholic District School Board to conduct a re-assessment of the condition of known friable asbestos-containing materials (ACM) and a visual inspection for mould at St. Peter Canisius School located at 424 Victoria Street in Watford, Ontario.

The school is a single storey structure, with a total area of 13,000 square feet. The original building was constructed in 1959. In addition to the investigation for asbestos and mould, the school was evaluated for the presence of any other designated substances.

Under the *Occupational Health & Safety Act* (OSHA), an owner must determine whether any Designated Substances are present at a site and is required to prepare a list of all Designated Substances that are present. These substances may require special handling procedures. The current OSHA regulation lists the following eleven (11) substances as Designated Substances in the workplace: acrylonitrile, arsenic, asbestos, benzene, coke oven emissions, ethylene oxide, isocyanates, lead, mercury, silica and vinyl chloride.

Based on the estimated construction date and the reported use of the building, the review undertaken by exp targeted asbestos, lead, mercury, and silica which, in our experience, are most likely to be present on-site.

The following report explains our survey methodology and summarizes the hazardous building materials found at the Site.

## 2.0 SURVEY METHODOLOGY

During this investigation the surveyor inspected the building for construction material suspected of containing asbestos after reviewing previous reports and database information. In addition, the surveyor inspected the building for construction materials suspected of containing other Designated Substances.

Note:

- Repetitive testing was generally not performed. Items, which were visually similar to others tested, were considered to be of like material and were not sampled again. However, due to the variable nature of some products, several samples may have been collected of some materials.
- No destructive testing was performed. The inaccessible spaces within the building were not inspected. This includes areas above plaster or

drywall ceilings (in the absence of access panels) as well as shafts, chases and bulkheads. Similarly, doors, motors and other equipment were not disassembled to determine composition.

- Vinyl sheet flooring and vinyl asbestos tiles have been recorded where observed, but may not be identified where they are present beneath multiple layers of flooring.

There was no access to the roof at the time of the assessment.

## **2.1 Asbestos**

No additional asbestos bulk samples were collected as a part of this re-assessment.

## **2.2 Other Hazardous Building Materials and Designated Substances**

All other hazardous building materials or Designated Substances were identified based on visual assessment and historical usage.

## **3.0 REGULATORY REQUIREMENTS**

“Designated Substance” as defined by the Ontario *Occupational Health & Safety Act* (OHSa) means “a biological, chemical or physical agent or combination thereof prescribed as a Designated Substance to which the exposure of a worker is prohibited, regulated, restricted, limited or controlled.” Under Section 30 of the OHSa an owner is required to determine whether any Designated Substances are present at a project site before beginning construction. If any portion of the project is tendered, the person issuing the tenders is required to list the Designated Substances present at the project site. The constructor is then required to ensure that every contractor and sub-contractor receives a copy of the list.

Effective as of July 1<sup>st</sup> 2010 in Ontario, all Designated Substances are regulated within a single amalgamated regulation, Ontario Regulation 490/09.

The Ministry of Labour (MOL) has issued a regulation (Ontario Regulation 278/05) with respect to the disturbance of asbestos on construction projects and has drafted guidelines for control of lead and silica exposures on construction projects.

Ontario Regulation 278/05 classifies all disturbance of asbestos as Type 1, Type 2 or Type 3, each of which is associated with defined work practises. All asbestos material waste is subject to special handling and disposal practices,

and must be removed prior to partial or full demolition. Removal of any quantity of asbestos of more than 1m<sup>2</sup> requires notification of the MOL. Disposal of asbestos waste is subject to waste management regulations under Ontario Regulation 347/90 as amended to Ontario Regulation 102/07.

The MOL guideline for the control of lead exposures during the removal of lead on construction projects does not include criteria for categorizing lead paint. The Ontario Ministry of Labour (MOL) does not have a standard to state what percentage of lead a material must have to be considered lead-containing. However, the designated substance regulation (DSR) for lead, Regulation 843, specifies occupational exposure limits (OELs) for lead and, where necessary, requires implementation of a control program to ensure compliance with these OELs. The time-weighted average (TWA) OEL for lead (i.e., all lead except tetraethyl lead) is: 0.05 milligrams per cubic metre (mg/m<sup>3</sup>) of air. However, under Subsection 3(3) of the Regulation, construction projects are excluded from the OELs and most of the other requirements of the Regulation. This exclusion should not be interpreted as meaning nothing is to be done for construction workers who are exposed to lead. The OELs establish an Ontario standard for worker protection from lead. Procedures that provide an equivalent level of protection should, therefore, be implemented on construction projects where exposure to lead is a hazard. Ensuring such procedures are in place would, in the words of clause 25(2)(h) of the *Occupational Health and Safety Act* (OHSA), be “taking reasonable precautions to protect the health and safety of workers”.

There are currently no regulations specifically covering exposure to mould or outlining mould remediation practices. In addition, there are no occupational exposure limits stating acceptable levels of exposure without adverse health effects.

However, Sections 25 and 27 of the Ontario *Occupational Health and Safety Act* states that an employer must take every reasonable precaution to ensure the health and safety of their workers. This includes exposure to moulds.

## **4.0 RESULTS**

### **4.1 Asbestos-Containing Materials**

Asbestos is a general name for several varieties of highly fibrous silicate minerals. Commercially significant types of asbestos include chrysotile, amosite and crocidolite. The fibres are valued for their heat and chemical resistance properties. The combination of fibrous structures, low heat conductivity, high electrical resistance, chemical inertness, strength and flexibility, as well as its effectiveness as a reinforcing or binding agent when combined with cement and/or plastic, made asbestos popular for widespread industrial use.

One measure of the potential hazard of ACM is its friability. The Ontario Ministry of Labour asbestos regulation defines a friable material as one when dry can be crumbled, pulverized or powdered by hand pressure. The friability of ACM is considered a significant indicator of the ease with which fibres may be released into the air. Non-friable products with bound asbestos pose no danger of releasing airborne fibres unless cut, broken up or otherwise physically abraded.

The following is a summary of the asbestos-containing or asbestos-suspect materials that were encountered at St. Peter Canisius School. A detailed summary of asbestos materials identified in the building are included in Appendix II.

#### **4.1.1 Sprayed Thermal Insulation**

Vermiculite above Equipment Room contains <0.5% actinolite (identified by others). While this concentration of asbestos would be considered non-asbestos under the provincial legislation, disturbance of this product should be controlled by a minimum of Type 2 asbestos procedures.

#### **4.1.2 Texture Finishes**

New non-asbestos texture coat is present in the corridor.

#### **4.1.3 Acoustic Ceiling Tiles**

No asbestos-containing acoustic tiles were encountered in the re-assessment of this facility.

#### **4.1.4 Mechanical Insulation**

Both asbestos and non-asbestos mechanical insulations are present within this building. In general, straight run pipe insulation present is fiberglass. Parging cement present on fittings and elbows contains chrysotile asbestos.

#### **4.1.5 Plaster and Drywall**

No plaster finishes were noted in the school.

Drywall compound used in construction prior to 1988 should be considered asbestos-suspect.

#### **4.1.6 Asbestos Cement Sheets**

No asbestos cement or "transite" products were encountered in the re-assessment of this facility.

#### **4.1.7 Vinyl Floor Tiles**

The vinyl floor tiles in the facility have been assumed to contain asbestos. These products are non-friable, and as such are not expected to release airborne asbestos fibre under normal conditions of building use. If a large quantity of floor tile is to be removed, it may be practical to verify the presence of asbestos at that time.

#### **4.2 Lead**

Painted finishes in the building were not sampled. Lead may be present in some finishes within the building.

#### **4.3 Mercury**

Mercury is present in thermostats and within fluorescent light tubes located within the building.

#### **4.4 Silica**

Common construction sand contains free crystalline silica and is present in concrete products, mortar, brick, etc. These construction products are typically found throughout building structures.

#### **4.5 Acrylonitrile, Benzene, Isocyanates, Arsenic, Ethylene Oxide, Vinyl Chloride and Coke Oven Emissions**

Evidence suggesting the presence of acrylonitrile, benzene, isocyanates, arsenic, ethylene oxide, vinyl chloride monomer or coke oven emissions was not observed at St. Peter Canisius School.

#### **4.6 Mould**

In recent years, contamination of buildings with mould has become a major concern. Mould growth will occur on any water damaged building material. Evidence does exist to support the relationship between exposure to mould in buildings and many health effects.

This re-assessment included the inspection of areas for visible mould growth. In the absence of occupants experiencing symptoms, the inspection for and remediation of visible mould present in the building will be an appropriate response to the issue. Where occupants are experiencing symptoms, in the absence of visible mould growth, some invasive inspection may be necessary to find potential sources of mould. In general this was beyond the scope of this assessment.

Locations where water stained/damaged tiles were identified are outlined in the following table:

Location	Quantity of Water Damaged Material
<b>Loc 27 Corridor</b>	2 stained ceiling tiles.
<b>New Corridor</b>	7 stained ceiling tiles.
<b>Room 202A</b>	1stained ceiling tile.
<b>Room 205</b>	2 stained ceiling tiles.

## 5.0 RECOMMENDATIONS

The following recommendations are made with respect to Designated Substances noted at St. Peter Canisius School:

### 5.1 Asbestos

#### 5.1.1 Asbestos Management Program

Since asbestos-containing materials were identified at this facility, the building is subject to the requirement for an Asbestos Management Program, as specified under Ontario Regulation 278/05.

#### 5.1.2 Specific Recommendations

##### 5.1.2.1 Mechanical Insulation

Any activity, which will disturb asbestos-containing mechanical insulation, is governed by the procedures outlined in Reg. 278/05. The disturbance of less than nine linear feet (or nine parged fittings or nine square feet of parging cement) of asbestos-containing mechanical insulation may be performed as a Type 2 operation, while any greater disturbance requires Type 3 precautions.

##### 5.1.2.2 Plaster and Drywall Compound

The sampling of drywall compound was not performed during this assessment. If any disturbance of these materials is planned, sampling should be performed in advance.

Removal of more than 1 square metre (9 square feet), of drywall compound containing asbestos requires Type 2 procedures under Reg. 278/05.



### 5.1.2.3 Vinyl Floor Tiles

Vinyl floor tiles may be removed, with manually powered tools, following the Type 1 procedures outlined in Reg. 278/05. The use of powered equipment on non-friable asbestos materials, an activity which could result in the release of airborne fibre, must be performed under Type 3 precautions.

## 5.2 Lead

Although samples were not collected, it should be assumed that lead is present within paint finishes at the site. As a result, the handling or disturbance of painted finishes should be evaluated to help ensure that workers are not adversely affected.

The lead-containing materials in the building will not generate airborne lead dust in the absence of disturbance. However, significant lead dust levels can result when uncontrolled work procedures are used on lead-based materials. The control of dust levels during the demolition of the buildings can be accomplished through proper work practises such as wetting the surface of the materials to reduce overall dust levels and providing workers with washing facilities and proper respiratory protection.

The procedures outlined in the MOL document 'Guideline – Lead on Construction Projects' (2004) should provide an adequate standard for the handling or disturbance of the material.

The disposal of construction waste containing lead is controlled under Ontario Regulation 347, as amended by O. Reg. 102/07, and may be subject to Leachate Criteria (Schedule 4) of this regulation.

## 5.3 Mercury

The presence of mercury in fluorescent light tubes and thermostats poses minimal risk to occupants or workers provided the equipment is handled properly and the mercury is not allowed to escape. In the event of future renovations, light tubes and thermostat tubes should be removed intact to prevent the mercury vapour from escaping.

It is good management practice to take precautions to prevent mercury vapours from becoming airborne during building demolition. Exposure to airborne mercury is regulated under Ontario Regulation 490/09, Regulation Respecting Mercury - made under the *Occupational Health and Safety Act*. The current TWAEV for mercury vapour is 0.025 mg/m<sup>3</sup> (except alkyl compounds).

Mercury waste must be handled and disposed of according to Ontario Regulation 347, as amended by O. Reg. 102/07, and may be subject to Leachate Criteria (Schedule 4) of this regulation.

#### **5.4 Silica**

Disturbance of materials containing silica will occur during demolition of walls and ceilings, saw cutting floor slabs and removal of lay-in acoustic ceiling tiles containing silica and is regulated under Ontario Regulation 490/09. The current TWAEV for amorphous fused silica is  $0.1 \text{ mg/m}^3$  and is  $0.05 \text{ mg/m}^3$  for crystalline silica (quartz). This can be accomplished through proper work practises such as wetting the surface of the materials to reduce overall dust levels and providing workers with washing facilities and proper respiratory protection.

#### **5.5 Mould**

Moisture issues are the only factor in the growth of mould that may be controlled by the building operator. Any existing moisture problems in the building must be addressed to prevent or control mould growth. The following general recommendations are made to reduce the potential for future mould growth within the building:

- Promptly respond to any water infiltration, including minor leaks.
- Where HVAC units permit, maintain relative humidity below 60%.
- Maintain caulking at sinks, bathrooms and at exterior locations.

In the event of a flood, remove water by pumping or vacuuming as soon as possible. Drying of construction and finishing materials must begin promptly (in less than 24 hours). It may be practical to remove and dispose of some wetted materials, (e.g. drywall and carpet) in some cases.

## 6.0 LIMITATIONS AND WARRANTY

Exp has prepared this report for the exclusive use of the Client in evaluating the Site at the time of exp's assessment. Exp will not be responsible for the use of this report by any third party, or reliance on or any decision to be made based on it without the prior written consent of exp. Exp accepts no responsibility for damages, if any, by any third party because of decisions or actions based on this report.

The findings and conclusions documented in this report have been prepared for specific application to this project and have been developed in a manner consistent with that level of care and skill normally exercised by qualified professionals currently practising in this area of environmental assessment. No other warranty, expressed or implied, is made.

The findings contained in this report are based upon conditions as they were observed at the time of investigation. No assurance is made regarding changes in conditions subsequent to the time of investigation.

If new information is developed in future work, exp should be contacted to re-evaluate the conclusions of this report and to provide amendments as required.

Respectfully submitted,

**Exp Services Inc.,**

A handwritten signature in black ink, appearing to read 'K. Olson', with a long horizontal line extending to the right.

Kris Olson, P.Eng.  
Senior Project Manager

**APPENDIX I**  
**BULK SAMPLING RESULTS**  
**(From Previous Assessments)**

## Pinchin Environmental Asbestos Samples Report

**Project #:** 13256

**Client Name:** St. Clair Catholic District School Board

**Building #:** 11

**Building Name:** St. Peter Canisius School Watford

**Survey Date:** 08/22/2007

Sample Number	System	Material	Location Number	Has Asbestos	Phase One		Phase Two		Description
					Asb. Type	Result	Asb. Type	Result	
0001	Piping	Parging Cement	1	<input checked="" type="checkbox"/>	Chrysotile	50-75%	None Detected	ND	Parging cement pipe fittings
0002	Floor	Vinyl sheet (flooring)	2	<input type="checkbox"/>	None Detected	ND	None Detected	NR	Vinyl sheet flooring
0003	Ceiling	Glued-on tiles	4	<input type="checkbox"/>	None Detected	ND	None Detected	NR	Stuck-on ceiling tiles
0004	Ceiling	Lay-in tiles	5	<input type="checkbox"/>	None Detected	ND	None Detected	NR	Lay-in ceiling tiles
0005	Ceiling	Lay-in tiles	6	<input type="checkbox"/>	None Detected	ND	None Detected	NR	Lay-in ceiling tiles
0006	Ceiling	Texture Coat	8	<input checked="" type="checkbox"/>	Chrysotile	0.5-5. %	None Detected	NR	Texture coat
0007	Ceiling	Lay-in tiles	26	<input type="checkbox"/>	None Detected	ND	None Detected	NR	Lay-in ceiling tiles
0008	Ceiling	Lay-in tiles	29	<input type="checkbox"/>	None Detected	ND	None Detected	NR	Lay-in ceiling tiles
0009	Ceiling	Lay-in tiles	30	<input type="checkbox"/>	None Detected	ND	None Detected	NR	Lay-in ceiling tiles
0010	Floor	Vinyl sheet (flooring)	36	<input type="checkbox"/>	None Detected	ND	None Detected	NR	Vinyl sheet flooring
0011	Floor	Vinyl sheet (flooring)	37	<input type="checkbox"/>	None Detected	ND	None Detected	NR	Vinyl sheet flooring
0012	Ceiling	Drywall	1	<input checked="" type="checkbox"/>	Chrysotile	<0.5%	No Result	NR	Drywall compound
0013	Piping	Parging Cement	24	<input checked="" type="checkbox"/>	Chrysotile	50-75%	None Detected	ND	Parging cement debris
0014	Other	Thermal Insulation (Sprayed)	21	<input type="checkbox"/>	None Detected	ND	No Result	NR	Thermal vermiculite

**APPENDIX II**

**UPDATED ROOM-BY-ROOM ASBESTOS MATERIALS SUMMARY**

**Pinchin Environmental**  
**All Data**

**Project #: 13256**

**Client Name: St. Clair Catholic District School Board**

**Building #: 11**

**Building Name: St. Peter Canisius School Watford**

**Survey Date: 06/12/2010**

**Location #: 1**

**BOILER ROOM**

**Floor: 1**

**Room Number: 305 P**

**Surveyor**

System	Layer	System Component		Component Material		Component Item	Component Covering	Access	Visible	Condition						Units	Sample Number	Hazard
		Description	Code	Description	Code					Good	Action	Fair	Action	Poor	Action			
Ceiling	1	Not Applicable	N/A	Drywall	014	Not Applicable	Not Applicable	C	Yes	120	(5)	120	(5)	0	(-)	SF	V 9000	Asbestos
Duct	1	Not Applicable	N/A	Not Insulated	099	Not Applicable	Not Applicable	C	Yes	0	(-)	0	(-)	0	(-)	NI	V 0000	None
Floor	1	Not Applicable	N/A	Concrete(poured)	002	Not Applicable	Not Applicable	A	Yes	0	(-)	0	(-)	0	(-)	SF	V 0000	None
Mechanical	1	Boiler	BLR	Fibreglass	028	Not Applicable	Metal	B	Yes	0	(-)	0	(-)	0	(-)	NI	V 0000	None
Mechanical	1	Breeching	BRE	Not Insulated	099	Not Applicable	Not Applicable	B	Yes	0	(-)	0	(-)	0	(-)	NI	V 0000	None
Mechanical	1	Domestic Hot Water	DHWT	Fibreglass	028	Not Applicable	Not Applicable	B	Yes	0	(-)	0	(-)	0	(-)	NI	V 0000	None
Mechanical	1	Furnace	FURN	Not Insulated	099	Not Applicable	Not Applicable	B	Yes	0	(-)	0	(-)	0	(-)	NI	V 0000	None
Mechanical	1		WMTR	Not Insulated	099	Not Applicable	Not Applicable	B	Yes	0	(-)	0	(-)	0	(-)	NI	V 0000	None
Piping	1	Domestic Cold Water	DCW	Fibreglass	028	Straight	Cheesecloth	B	Yes	0	(-)	0	(-)	0	(-)	NI	V 0000	None
Piping	1	Domestic Hot Water	DHW	Fibreglass	028	Straight	Cheesecloth	B	Yes	0	(-)	0	(-)	0	(-)	NI	V 0000	None
Piping	1	Heating Water Return	HWR	Fibreglass	028	Straight	Cheesecloth	C	Yes	0	(-)	0	(-)	0	(-)	NI	V 0000	None
Piping	1	Heating Water Supply	HWS	Fibreglass	028	Straight	Cheesecloth	B	Yes	0	(-)	0	(-)	0	(-)	NI	V 0000	None
Structure	1	Not Found	N/F	Not Applicable	N/A	Not Applicable	Not Applicable	NI	No	0	(-)	0	(-)	0	(-)	NI	V 0000	None
Walls	1	Not Applicable	N/A	Masonry	019	Not Applicable	Not Applicable	A	Yes	0	(-)	0	(-)	0	(-)	SF	V 0000	None
Piping	1	Domestic Water (Hot &	DW	Parging Cement	031	Fitting	Cheesecloth	C	Yes	2	(5)	0	(-)	1	(5)	EA	V 0001	Asbestos
Piping	1	Domestic Water (Hot &	DW	Fibreglass	028	Straight	Cheesecloth	C	Yes	0	(-)	0	(-)	0	(-)	NI	V 0000	None
Other	1	Door	DOOR	Not Applicable	N/A	Not Applicable	Not Applicable	B	Yes	1	(8)	NE	(-)	NE	(-)	EA	V 9500	Suspect

**Legend:**

Access	Condition	Action	Sample Number
A - Accessible To All Building Occupants.	Good - No Visible damage or exposed material.	(-) No Action Required.	S #### Sample Collected.
B - Accessible To Maintenance Staff	Fair - Repairable Damage with minor amounts of exposed material.	(1) Immediate clean-up of debris or damaged ACM likely to be disturbed	V #### Material is visually identified to be identical to S ####.
C - Accessible To Maintenance Staff With a Ladder.	Poor - Irreparable damage with exposed & missing material.	(2) Type 2 precautions for entry into areas with ACM debris	V 0000 Material is visually identified to contain no asbestos.
D - Not Accessible.	Note: Sprayed Materials are only rated as Good or Poor.	(3) ACM removal required	V 9000 Material is visually identified to contain asbestos.
		(4) Type 2 precautions for entry into areas where ACM is present	V 9500 Material is suspected to contain asbestos.
		(5) Proactive ACM removal	Note: Vinyl Tiles, Vinyl sheet Flooring, Drywall, Plaster and Textured Finish (Coat) are considered suspect materials if not sampled.
		(6) Proactive ACM repair	
		(7) Management program and surveillance	
		(8) Suspect Material	

Units : SF - Square Feet LF - Linear Feet EA - Each % - Percentage

**Pinchin Environmental**  
**All Data**

**Project #:** 13256

**Client Name:** St. Clair Catholic District School Board

**Building #:** 11

**Building Name:** St. Peter Canisius School Watford

**Survey Date:** 06/12/2010

**Location #:** 1

**BOILER ROOM**

**Floor:** 1

**Room Number:** 305 P

**Surveyor**

(cont'd)

System	Layer	System Component		Component Material		Component Item	Component Covering	Access	Visible	Condition						Units	Sample Number	Hazard
		Description	Code	Description	Code					Good	Action	Fair	Action	Poor	Action			
Piping	1	Debris (Fallen)	DBRS	Parging Cement	031	Fitting	Not Applicable	B	Yes	0	(-)	0	(-)	1	(1)	EA	V 0001	Asbestos

Surveyor Notes: Parging cement debris on hot water heater.  
No access 2012.

**Location #:** 2

**CLASSROOM**

**Floor:** 1

**Room Number:** 106 A

**Surveyor**

System	Layer	System Component		Component Material		Component Item	Component Covering	Access	Visible	Condition						Units	Sample Number	Hazard
		Description	Code	Description	Code					Good	Action	Fair	Action	Poor	Action			
Ceiling	1	Not Applicable	N/A	Drywall	014	Not Applicable	Not Applicable	D	No	1250	(7)	0	(-)	0	(-)	SF	V 9000	Asbestos
Ceiling	1	Patterned pinholes -	AT-001	Glued-on tiles	005	Not Applicable	Not Applicable	C	Yes	1250	(-)	0	(-)	0	(-)	SF	V 0016	None
Duct	1	Not Found	N/F	Not Applicable	N/A	Not Applicable	Not Applicable	NI	No	0	(-)	0	(-)	0	(-)	NI	V 0000	None
Floor	1	Not Applicable	N/A	Vinyl tiles	008	Not Applicable	Not Applicable	A	Yes	1250	(7)	0	(-)	0	(-)	SF	V 9000	Asbestos
Floor	1	Not Applicable	N/A	Vinyl sheet	009	Not Applicable	Not Applicable	A	Yes	50	(-)	0	(-)	0	(-)	SF	S 0002	None
Mechanical	1	Not Found	N/F	Not Applicable	N/A	Not Applicable	Not Applicable	NI	No	0	(-)	0	(-)	0	(-)	NI	V 0000	None
Piping	1	Hot Water Heating	HWH	Fibreglass	028	Straight	Paper	A	Yes	0	(-)	0	(-)	0	(-)	NI	V 0000	None
Structure	1	Not Found	N/F	Not Applicable	N/A	Not Applicable	Not Applicable	NI	No	0	(-)	0	(-)	0	(-)	NI	V 0000	None
Walls	1	Not Applicable	N/A	Drywall	014	Not Applicable	Not Applicable	A	Yes	100	(7)	0	(-)	0	(-)	%	V 9000	Asbestos

**Legend:**

Access	Condition	Action	Sample Number
A - Accessible To All Building Occupants.	Good - No Visible damage or exposed material.	(-) No Action Required.	S #### Sample Collected.
B - Accessible To Maintenance Staff	Fair - Repairable Damage with minor amounts of exposed material.	(1) Immediate clean-up of debris or damaged ACM likely to be disturbed	V #### Material is visually identified to be identical to S ####.
	Poor - Irreparable damage with exposed & missing material.	(2) Type 2 precautions for entry into areas with ACM debris	V 0000 Material is visually identified to contain no asbestos.
C - Accessible To Maintenance Staff With a Ladder.	Note: Sprayed Materials are only rated as Good or Poor.	(3) ACM removal required	V 9000 Material is visually identified to contain asbestos.
D - Not Accessible.		(4) Type 2 precautions for entry into areas where ACM is present	V 9500 Material is suspected to contain asbestos.
		(5) Proactive ACM removal	Note: Vinyl Tiles, Vinyl sheet Flooring, Drywall, Plaster and Textured Finish (Coat) are considered suspect materials if not sampled.
		(6) Proactive ACM repair	
		(7) Management program and surveillance	
		(8) Suspect Material	

Units : SF - Square Feet LF - Linear Feet EA - Each % - Percentage



**Pinchin Environmental**  
**All Data**

**Project #: 13256**

**Client Name: St. Clair Catholic District School Board**

**Building #: 11**

**Building Name: St. Peter Canisius School Watford**

**Survey Date: 06/12/2010**

**Location #: 2**

**CLASSROOM**

**Floor: 1**

**Room Number: 106 A**

**Surveyor**

(cont'd)

System	Layer	System Component		Component Material		Component Item	Component Covering	Access	Visible	Condition						Units	Sample Number	Hazard
		Description	Code	Description	Code					Good	Action	Fair	Action	Poor	Action			
Walls	1	Not Applicable	N/A	Masonry	019	Not Applicable	Not Applicable	A	Yes	0	(-)	0	(-)	0	(-)	SF	V 0000	None
Piping	1	Hot Water Heating	HWH	Fibreglass	028	Fitting	Paper	A	Yes	0	(-)	0	(-)	0	(-)	NI	V 0000	None
Piping	1	Domestic Water (Hot &	DW	Not Insulated	099	Straight		A	Yes	0	(-)	0	(-)	0	(-)	NI	V 0000	None
Piping	1	Domestic Water (Hot &	DW	Not Insulated	099	Fitting		A	Yes	0	(-)	0	(-)	0	(-)	NI	V 0000	None

Surveyor Notes: MERCURY THERMOSTAT IS PRESENT AT THIS LOCATION.

**Location #: 3**

**CLASSROOM**

**Floor: 1**

**Room Number: 405 A**

**Surveyor**

System	Layer	System Component		Component Material		Component Item	Component Covering	Access	Visible	Condition						Units	Sample Number	Hazard
		Description	Code	Description	Code					Good	Action	Fair	Action	Poor	Action			
Ceiling	1	Not Applicable	N/A	Drywall	014	Not Applicable	Not Applicable	D	No	600	(7)	0	(-)	0	(-)	SF	V 9000	Asbestos
Ceiling	1	Patterned pinholes -	AT-001	Glued-on tiles	005	Not Applicable	Not Applicable	C	Yes	600	(-)	0	(-)	0	(-)	SF	V 0000	None
Duct	1	Not Found	N/F	Not Applicable	N/A	Not Applicable	Not Applicable	NI	No	0	(-)	0	(-)	0	(-)	NI	V 0000	None
Floor	1	Not Applicable	N/A	Vinyl tiles	008	Not Applicable	Not Applicable	A	Yes	600	(7)	0	(-)	0	(-)	SF	V 9000	Asbestos
Mechanical	1	Not Found	N/F	Not Applicable	N/A	Not Applicable	Not Applicable	NI	No	0	(-)	0	(-)	0	(-)	NI	V 0000	None
Piping	1	Not Found	N/F	Not Applicable	N/A	Not Applicable	Not Applicable	NI	No	0	(-)	0	(-)	0	(-)	NI	V 0000	None

**Legend:**

Access	Condition	Action	Sample Number
A - Accessible To All Building Occupants.	Good - No Visible damage or exposed material.	(-) No Action Required.	S #### Sample Collected.
B - Accessible To Maintenance Staff	Fair - Repairable Damage with minor amounts of exposed material.	(1) Immediate clean-up of debris or damaged ACM likely to be disturbed	V #### Material is visually identified to be identical to S ####.
C - Accessible To Maintenance Staff With a Ladder.	Poor - Irreparable damage with exposed & missing material.	(2) Type 2 precautions for entry into areas with ACM debris	V 0000 Material is visually identified to contain no asbestos.
D - Not Accessible.	Note: Sprayed Materials are only rated as Good or Poor.	(3) ACM removal required	V 9000 Material is visually identified to contain asbestos.
		(4) Type 2 precautions for entry into areas where ACM is present	V 9500 Material is suspected to contain asbestos.
		(5) Proactive ACM removal	Note: Vinyl Tiles, Vinyl sheet Flooring, Drywall, Plaster and Textured Finish (Coat) are considered suspect materials if not sampled.
		(6) Proactive ACM repair	
		(7) Management program and surveillance	
		(8) Suspect Material	

Units : SF - Square Feet LF - Linear Feet EA - Each % - Percentage

**Pinchin Environmental**  
**All Data**

**Project #:** 13256

**Client Name:** St. Clair Catholic District School Board

**Building #:** 11

**Building Name:** St. Peter Canisius School Watford

**Survey Date:** 06/12/2010

**Location #:** 3

**CLASSROOM**

**Floor:** 1

**Room Number:** 405 A

**Surveyor**

(cont'd)

System	Layer	System Component		Component Material		Component Item	Component Covering	Access	Visible	Condition						Units	Sample Number	Hazard
		Description	Code	Description	Code					Good	Action	Fair	Action	Poor	Action			
Structure	1	Not Found	N/F	Not Applicable	N/A	Not Applicable	Not Applicable	NI	No	0	(-)	0	(-)	0	(-)	NI	V 0000	None
Walls	1	Not Applicable	N/A	Drywall	014	Not Applicable	Not Applicable	A	Yes	100	(7)	0	(-)	0	(-)	%	V 9000	Asbestos
Walls	1	Not Applicable	N/A	Masonry	019	Not Applicable	Not Applicable	A	Yes	0	(-)	0	(-)	0	(-)	SF	V 0000	None
Ceiling	1		NI	Drywall	014	Not Applicable		A	Yes	50	(5)	NE	(-)	NE	(-)	NE	V 9000	Asbestos

Surveyor Notes: MERCURY THERMOSTAT IS PRESENT AT THIS LOCATION.

**Location #:** 4

**CLASSROOM**

**Floor:** 1

**Room Number:** 104 A

**Surveyor**

System	Layer	System Component		Component Material		Component Item	Component Covering	Access	Visible	Condition						Units	Sample Number	Hazard
		Description	Code	Description	Code					Good	Action	Fair	Action	Poor	Action			
Ceiling	1	Patterned pinholes -	AT-001	Glued-on tiles	005	Not Applicable	Not Applicable	C	Yes	800	(-)	0	(-)	0	(-)	SF	V 0000	None
Ceiling	1	No pattern	AT-002	Glued-on tiles	005	Not Applicable	Not Applicable	C	Yes	100	(-)	0	(-)	0	(-)	SF	S 0003	None
Duct	1	Not Found	N/F	Not Applicable	N/A	Not Applicable	Not Applicable	NI	No	0	(-)	0	(-)	0	(-)	NI	V 0000	None
Floor	1	Not Applicable	N/A	Vinyl tiles	008	Not Applicable	Not Applicable	A	Yes	800	(7)	0	(-)	0	(-)	SF	V 9000	Asbestos
Mechanical	1	Not Found	N/F	Not Applicable	N/A	Not Applicable	Not Applicable	NI	No	0	(-)	0	(-)	0	(-)	NI	V 0000	None
Structure	1	Not Found	N/F	Not Applicable	N/A	Not Applicable	Not Applicable	NI	No	0	(-)	0	(-)	0	(-)	NI	V 0000	None

**Legend:**

Access	Condition	Action	Sample Number
A - Accessible To All Building Occupants.	Good - No Visible damage or exposed material.	(-) No Action Required.	S #### Sample Collected.
B - Accessible To Maintenance Staff	Fair - Repairable Damage with minor amounts of exposed material.	(1) Immediate clean-up of debris or damaged ACM likely to be disturbed	V #### Material is visually identified to be identical to S ####.
C - Accessible To Maintenance Staff With a Ladder.	Poor - Irreparable damage with exposed & missing material.	(2) Type 2 precautions for entry into areas with ACM debris	V 0000 Material is visually identified to contain no asbestos.
D - Not Accessible.	Note: Sprayed Materials are only rated as Good or Poor.	(3) ACM removal required	V 9000 Material is visually identified to contain asbestos.
		(4) Type 2 precautions for entry into areas where ACM is present	V 9500 Material is suspected to contain asbestos.
		(5) Proactive ACM removal	Note: Vinyl Tiles, Vinyl sheet Flooring, Drywall, Plaster and Textured Finish (Coat) are considered suspect materials if not sampled.
		(6) Proactive ACM repair	
		(7) Management program and surveillance	
		(8) Suspect Material	

Units : SF - Square Feet LF - Linear Feet EA - Each % - Percentage

**Pinchin Environmental**  
**All Data**

**Project #: 13256**

**Client Name: St. Clair Catholic District School Board**

**Building #: 11**

**Building Name: St. Peter Canisius School Watford**

**Survey Date: 06/12/2010**

**Location #: 4**

**CLASSROOM**

**Floor: 1**

**Room Number: 104 A**

**Surveyor**

(cont'd)

System	Layer	System Component		Component Material		Component Item	Component Covering	Access	Visible	Condition						Units	Sample Number	Hazard
		Description	Code	Description	Code					Good	Action	Fair	Action	Poor	Action			
Walls	1	Not Applicable	N/A	Masonry	019	Not Applicable	Not Applicable	A	Yes	0	(-)	0	(-)	0	(-)	SF	V 0000	None
Piping	1	Hot Water Heating	HWH	Fibreglass	028	Straight	Paper	A	Yes	0	(-)	0	(-)	0	(-)	NI	V 0000	None
Piping	1	Hot Water Heating	HWH	Fibreglass	028	Fitting	Paper	A	Yes	0	(-)	0	(-)	0	(-)	NI	V 0000	None

Surveyor Notes: MERCURY THERMOSTAT IS PRESENT AT THIS LOCATION.

**Location #: 5**

**COMPUTER ROOM**

**Floor: 1**

**Room Number: 114 A**

**Surveyor**

System	Layer	System Component		Component Material		Component Item	Component Covering	Access	Visible	Condition						Units	Sample Number	Hazard
		Description	Code	Description	Code					Good	Action	Fair	Action	Poor	Action			
Ceiling	1	Fissures with pinholes	AT-003	Lay-in tiles	006	Not Applicable	Not Applicable	C	Yes	240	(-)	0	(-)	0	(-)	SF	S 0004	None
Duct	1	Not Found	N/F	Not Applicable	N/A	Not Applicable	Not Applicable	NI	No	0	(-)	0	(-)	0	(-)	NI	V 0000	None
Floor	1	Not Applicable	N/A	Vinyl tiles	008	Not Applicable	Not Applicable	D	No	240	(7)	0	(-)	0	(-)	SF	V 9000	Asbestos
Floor	1	Not Applicable	N/A	Carpet	050	Not Applicable	Not Applicable	A	Yes	0	(-)	0	(-)	0	(-)	SF	V 0000	None
Mechanical	1	Not Found	N/F	Not Applicable	N/A	Not Applicable	Not Applicable	NI	No	0	(-)	0	(-)	0	(-)	NI	V 0000	None
Piping	1	Not Found	N/F	Not Applicable	N/A	Not Applicable	Not Applicable	NI	No	0	(-)	0	(-)	0	(-)	NI	V 0000	None
Structure	1	Not Found	N/F	Not Applicable	N/A	Not Applicable	Not Applicable	NI	No	0	(-)	0	(-)	0	(-)	NI	V 0000	None

**Legend:**

Access	Condition	Action	Sample Number
A - Accessible To All Building Occupants.	Good - No Visible damage or exposed material.	(-) No Action Required.	S #### Sample Collected.
B - Accessible To Maintenance Staff	Fair - Repairable Damage with minor amounts of exposed material.	(1) Immediate clean-up of debris or damaged ACM likely to be disturbed	V #### Material is visually identified to be identical to S ####.
	Poor - Irreparable damage with exposed & missing material.	(2) Type 2 precautions for entry into areas with ACM debris	V 0000 Material is visually identified to contain no asbestos.
C - Accessible To Maintenance Staff With a Ladder.	Note: Sprayed Materials are only rated as Good or Poor.	(3) ACM removal required	V 9000 Material is visually identified to contain asbestos.
D - Not Accessible.		(4) Type 2 precautions for entry into areas where ACM is present	V 9500 Material is suspected to contain asbestos.
			Note: Vinyl Tiles, Vinyl sheet Flooring, Drywall, Plaster and Textured Finish (Coat) are considered suspect materials if not sampled.

Units : SF - Square Feet LF - Linear Feet EA - Each % - Percentage

**Pinchin Environmental**  
**All Data**

**Project #: 13256**

**Client Name: St. Clair Catholic District School Board**

**Building #: 11**

**Building Name: St. Peter Canisius School Watford**

**Survey Date: 06/12/2010**

**Location #: 5**

**COMPUTER ROOM**

**Floor: 1**

**Room Number: 114 A**

**Surveyor**

(cont'd)

System	Layer	System Component		Component Material		Component Item	Component Covering	Access	Visible	Condition						Units	Sample Number	Hazard
		Description	Code	Description	Code					Good	Action	Fair	Action	Poor	Action			
Structure	1	Not Found	N/F	Not Applicable	N/A	Not Applicable	Not Applicable	NI	No	0	(-)	0	(-)	0	(-)	NI	V 0000	None
Walls	1	Not Applicable	N/A	Drywall	014	Not Applicable	Not Applicable	A	Yes	100	(7)	0	(-)	0	(-)	%	V 9000	Asbestos

Surveyor Notes:

**Location #: 6**

**COMPUTER ROOM**

**Floor: 1**

**Room Number: 103 A**

**Surveyor**

System	Layer	System Component		Component Material		Component Item	Component Covering	Access	Visible	Condition						Units	Sample Number	Hazard
		Description	Code	Description	Code					Good	Action	Fair	Action	Poor	Action			
Ceiling	1	Patterned pinholes -	AT-001	Glued-on tiles	005	Not Applicable	Not Applicable	C	Yes	700	(-)	0	(-)	0	(-)	SF	V 0000	None
Ceiling	1	Width fissures with	AT-004	Lay-in tiles	006	Not Applicable	Not Applicable	C	Yes	100	(-)	0	(-)	0	(-)	SF	S 0005	None
Duct	1	Not Applicable	N/A	Fibreglass	028	Not Applicable	Not Applicable	NI	No	0	(-)	0	(-)	0	(-)	NI	V 0000	None
Mechanical	1	Not Found	N/F	Not Applicable	N/A	Not Applicable	Not Applicable	NI	No	0	(-)	0	(-)	0	(-)	NI	V 0000	None
Piping	1	Not Found	N/F	Not Applicable	N/A	Not Applicable	Not Applicable	NI	No	0	(-)	0	(-)	0	(-)	NI	V 0000	None
Structure	1	Not Found	N/F	Not Applicable	N/A	Not Applicable	Not Applicable	NI	No	0	(-)	0	(-)	0	(-)	NI	V 0000	None
Walls	1	Not Applicable	N/A	Wood	004	Not Applicable	Not Applicable	A	Yes	0	(-)	0	(-)	0	(-)	SF	V 0000	None
Walls	1	Not Applicable	N/A	Masonry	019	Not Applicable	Not Applicable	A	Yes	0	(-)	0	(-)	0	(-)	SF	V 0000	None

**Legend:**

Access	Condition	Action	Sample Number
A - Accessible To All Building Occupants.	Good - No Visible damage or exposed material.	(-) No Action Required.	S #### Sample Collected.
B - Accessible To Maintenance Staff	Fair - Repairable Damage with minor amounts of exposed material.	(1) Immediate clean-up of debris or damaged ACM likely to be disturbed	V #### Material is visually identified to be identical to S ####.
	Poor - Irreparable damage with exposed & missing material.	(2) Type 2 precautions for entry into areas with ACM debris	V 0000 Material is visually identified to contain no asbestos.
C - Accessible To Maintenance Staff With a Ladder.	Note: Sprayed Materials are only rated as Good or Poor.	(3) ACM removal required	V 9000 Material is visually identified to contain asbestos.
D - Not Accessible.		(4) Type 2 precautions for entry into areas where ACM is present	V 9500 Material is suspected to contain asbestos.
		(5) Proactive ACM removal	Note: Vinyl Tiles, Vinyl sheet Flooring, Drywall, Plaster and Textured Finish (Coat) are considered suspect materials if not sampled.
		(6) Proactive ACM repair	
		(7) Management program and surveillance	
		(8) Suspect Material	

Units : SF - Square Feet LF - Linear Feet EA - Each % - Percentage

**Pinchin Environmental**  
**All Data**

**Project #:** 13256

**Client Name:** St. Clair Catholic District School Board

**Building #:** 11

**Building Name:** St. Peter Canisius School Watford

**Survey Date:** 06/12/2010

Surveyor Notes:

**Location #:** 7

**CLASSROOM**

**Floor:** 1

**Room Number:** 101 A

**Surveyor**

System	Layer	System Component		Component Material		Component Item	Component Covering	Access	Visible	Condition						Units	Sample Number	Hazard
		Description	Code	Description	Code					Good	Action	Fair	Action	Poor	Action			
Ceiling	1	Not Accessible	NAC	Drywall	014	Not Applicable	Not Applicable	D	No	800	(-)	0	(-)	0	(-)	SF	V 0000	None
Ceiling	1	Patterned pinholes -	AT-001	Glued-on tiles	005	Not Applicable	Not Applicable	C	Yes	800	(-)	0	(-)	0	(-)	SF	V 0016	None
Duct	1	Not Found	N/F	Not Applicable	N/A	Not Applicable	Not Applicable	NI	No	0	(-)	0	(-)	0	(-)	NI	V 0000	None
Floor	1	Not Applicable	N/A	Vinyl tiles	008	Not Applicable	Not Applicable	A	Yes	800	(-)	0	(-)	0	(-)	SF	V 0000	None
Mechanical	1	Not Found	N/F	Not Applicable	N/A	Not Applicable	Not Applicable	NI	No	0	(-)	0	(-)	0	(-)	NI	V 0000	None
Piping	1	Not Applicable	N/A	Not Insulated	099	Not Applicable	Not Applicable	C	No	0	(-)	0	(-)	0	(-)	NI	V 0000	None
Structure	1	Not Applicable	N/A	Wood	004	Not Applicable	Not Applicable	C	No	0	(-)	0	(-)	0	(-)	NI	V 0000	None
Walls	1	Not Applicable	N/A	Masonry	019	Not Applicable	Not Applicable	A	Yes	100	(-)	0	(-)	0	(-)	%	V 0000	None

Surveyor Notes: MERCURY THERMOSTAT PRESENT AT THIS LOCATION.

**Legend:**

Access	Condition	Action	Sample Number
A - Accessible To All Building Occupants.	Good - No Visible damage or exposed material.	(-) No Action Required.	S #### Sample Collected.
B - Accessible To Maintenance Staff	Fair - Repairable Damage with minor amounts of exposed material.	(1) Immediate clean-up of debris or damaged ACM likely to be disturbed	V #### Material is visually identified to be identical to S ####.
C - Accessible To Maintenance Staff With a Ladder.	Poor - Irreparable damage with exposed & missing material.	(2) Type 2 precautions for entry into areas with ACM debris	V 0000 Material is visually identified to contain no asbestos.
D - Not Accessible.	Note: Sprayed Materials are only rated as Good or Poor.	(3) ACM removal required	V 9000 Material is visually identified to contain asbestos.
		(4) Type 2 precautions for entry into areas where ACM is present	V 9500 Material is suspected to contain asbestos.
		(5) Proactive ACM removal	Note: Vinyl Tiles, Vinyl sheet Flooring, Drywall, Plaster and Textured Finish (Coat) are considered suspect materials if not sampled.
		(6) Proactive ACM repair	
		(7) Management program and surveillance	
		(8) Suspect Material	

Units : SF - Square Feet LF - Linear Feet EA - Each % - Percentage

**Pinchin Environmental**  
**All Data**

**Project #: 13256**

**Client Name: St. Clair Catholic District School Board**

**Building #: 11**

**Building Name: St. Peter Canisius School Watford**

**Survey Date: 06/12/2010**

**Location #: 8**

**STORAGE/MECHANICAL ROOM**

**Floor: 1**

**Room Number: 115 P**

**Surveyor**

System	Layer	System Component		Component Material		Component Item	Component Covering	Access	Visible	Condition						Units	Sample Number	Hazard
		Description	Code	Description	Code					Good	Action	Fair	Action	Poor	Action			
Duct	1	Not Applicable	N/A	Not Insulated	099	Not Applicable	Not Applicable	B	Yes	0	(-)	0	(-)	0	(-)	NI	V 0000	None
Floor	1	Not Applicable	N/A	Vinyl tiles	008	Not Applicable	Not Applicable	A	Yes	60	(7)	0	(-)	0	(-)	SF	V 9000	Asbestos
Mechanical	1	Furnace	FURN	Not Insulated	099	Not Applicable	Not Applicable	B	Yes	0	(-)	0	(-)	0	(-)	NI	V 0000	None
Piping	1	Not Applicable	N/A	Not Insulated	099	Not Applicable	Not Applicable	B	Yes	0	(-)	0	(-)	0	(-)	NI	V 0000	None
Structure	1	Not Found	N/F	Not Applicable	N/A	Not Applicable	Not Applicable	NI	No	0	(-)	0	(-)	0	(-)	NI	V 0000	None
Walls	1	Not Applicable	N/A	Masonry	019	Not Applicable	Not Applicable	A	Yes	0	(-)	0	(-)	0	(-)	SF	V 0000	None
Ceiling	1	Not Found	N/F		NE			NE	No	NE	(-)	NE	(-)	NE	(-)	NE	V 0000	None
Other	1	Door	DOOR	Not Applicable	N/A	Not Applicable	Not Applicable	B	Yes	1	(8)	NE	(-)	NE	(-)	EA	V 9500	Suspect

Surveyor Notes:

**Location #: 9**

**Office**

**Floor: 1**

**Room Number:**

**Surveyor**

System	Layer	System Component		Component Material		Component Item	Component Covering	Access	Visible	Condition						Units	Sample Number	Hazard
		Description	Code	Description	Code					Good	Action	Fair	Action	Poor	Action			
Ceiling	1	Patterned pinholes	AT-005	Lay-in tiles	006	Not Applicable	Not Applicable	C	Yes	100	(-)	0	(-)	0	(-)	SF	V 0007	None
Ceiling	1	Fissures and pinholes	AT-007	Lay-in tiles	006	Not Applicable	Not Applicable	C	Yes	20	(-)	0	(-)	0	(-)	SF	V 0009	None

**Legend:**

Access	Condition	Action	Sample Number
A - Accessible To All Building Occupants.	Good - No Visible damage or exposed material.	(-) No Action Required.	S #### Sample Collected.
B - Accessible To Maintenance Staff	Fair - Repairable Damage with minor amounts of exposed material.	(1) Immediate clean-up of debris or damaged ACM likely to be disturbed	V #### Material is visually identified to be identical to S ####.
C - Accessible To Maintenance Staff With a Ladder.	Poor - Irreparable damage with exposed & missing material.	(2) Type 2 precautions for entry into areas with ACM debris	V 0000 Material is visually identified to contain no asbestos.
D - Not Accessible.	Note: Sprayed Materials are only rated as Good or Poor.	(3) ACM removal required	V 9000 Material is visually identified to contain asbestos.
		(4) Type 2 precautions for entry into areas where ACM is present	V 9500 Material is suspected to contain asbestos.
		(5) Proactive ACM removal	Note: Vinyl Tiles, Vinyl sheet Flooring, Drywall, Plaster and Textured Finish (Coat) are considered suspect materials if not sampled.
		(6) Proactive ACM repair	
		(7) Management program and surveillance	
		(8) Suspect Material	

Units : SF - Square Feet LF - Linear Feet EA - Each % - Percentage

**Pinchin Environmental**  
**All Data**

**Project #: 13256**

**Client Name: St. Clair Catholic District School Board**

**Building #: 11**

**Building Name: St. Peter Canisius School Watford**

**Survey Date: 06/12/2010**

**Location #: 9**

**Office**

**Floor: 1**

**Room Number:**

**Surveyor**

(cont'd)

System	Layer	System Component		Component Material		Component Item	Component Covering	Access	Visible	Condition						Units	Sample Number	Hazard
		Description	Code	Description	Code					Good	Action	Fair	Action	Poor	Action			
Duct	1	Not Found	N/F	Not Applicable	N/A	Not Applicable	Not Applicable	NI	No	0	(-)	0	(-)	0	(-)	NI	V 0000	None
Mechanical	1	Not Found	N/F	Not Applicable	N/A	Not Applicable	Not Applicable	NI	No	0	(-)	0	(-)	0	(-)	NI	V 0000	None
Piping	1	Not Found	N/F	Not Applicable	N/A	Not Applicable	Not Applicable	NI	No	0	(-)	0	(-)	0	(-)	NI	V 0000	None
Structure	1	Not Found	N/F	Not Applicable	N/A	Not Applicable	Not Applicable	NI	No	0	(-)	0	(-)	0	(-)	NI	V 0000	None

Surveyor Notes:

**Location #: 10**

**STORAGE**

**Floor: 1**

**Room Number: 117 P**

**Surveyor**

System	Layer	System Component		Component Material		Component Item	Component Covering	Access	Visible	Condition						Units	Sample Number	Hazard
		Description	Code	Description	Code					Good	Action	Fair	Action	Poor	Action			
Ceiling	1	Patterned pinholes -	AT-001	Glued-on tiles	005	Not Applicable	Not Applicable	C	Yes	200	(-)	0	(-)	0	(-)	SF	V 0000	None
Duct	1	Not Found	N/F	Not Applicable	N/A	Not Applicable	Not Applicable	NI	No	0	(-)	0	(-)	0	(-)	NI	V 0000	None
Floor	1	Not Applicable	N/A	Vinyl tiles	008	Not Applicable	Not Applicable	A	Yes	200	(-)	0	(-)	0	(-)	SF	V 9000	None
Mechanical	1	Not Found	N/F	Not Applicable	N/A	Not Applicable	Not Applicable	NI	No	0	(-)	0	(-)	0	(-)	NI	V 0000	None
Piping	1	Not Found	N/F	Not Applicable	N/A	Not Applicable	Not Applicable	NI	No	0	(-)	0	(-)	0	(-)	NI	V 0000	None
Structure	1	Not Found	N/F	Not Applicable	N/A	Not Applicable	Not Applicable	NI	No	0	(-)	0	(-)	0	(-)	NI	V 0000	None

**Legend:**

Access	Condition	Action	Sample Number
A - Accessible To All Building Occupants.	Good - No Visible damage or exposed material.	(-) No Action Required.	S #### Sample Collected.
B - Accessible To Maintenance Staff	Fair - Repairable Damage with minor amounts of exposed material.	(1) Immediate clean-up of debris or damaged ACM likely to be disturbed	V #### Material is visually identified to be identical to S ####.
	Poor - Irreparable damage with exposed & missing material.	(2) Type 2 precautions for entry into areas with ACM debris	V 0000 Material is visually identified to contain no asbestos.
C - Accessible To Maintenance Staff With a Ladder.	Note: Sprayed Materials are only rated as Good or Poor.	(3) ACM removal required	V 9000 Material is visually identified to contain asbestos.
D - Not Accessible.		(4) Type 2 precautions for entry into areas where ACM is present	V 9500 Material is suspected to contain asbestos.
		(5) Proactive ACM removal	Note: Vinyl Tiles, Vinyl sheet Flooring, Drywall, Plaster and Textured Finish (Coat) are considered suspect materials if not sampled.
		(6) Proactive ACM repair	
		(7) Management program and surveillance	
		(8) Suspect Material	

Units : SF - Square Feet LF - Linear Feet EA - Each % - Percentage

**Pinchin Environmental**  
**All Data**

**Project #:** 13256

**Client Name:** St. Clair Catholic District School Board

**Building #:** 11

**Building Name:** St. Peter Canisius School Watford

**Survey Date:** 06/12/2010

**Location #:** 10

STORAGE

**Floor:** 1

**Room Number:** 117 P

**Surveyor**

(cont'd)

System	Layer	System Component		Component Material		Component Item	Component Covering	Access	Visible	Condition						Units	Sample Number	Hazard
		Description	Code	Description	Code					Good	Action	Fair	Action	Poor	Action			
Walls	1	Not Applicable	N/A	Wood	004	Not Applicable	Not Applicable	A	Yes	0	(-)	0	(-)	0	(-)	SF	V 0000	None
Walls	1	Not Applicable	N/A	Drywall	014	Not Applicable	Not Applicable	A	Yes	100	(7)	0	(-)	0	(-)	%	V 9000	Asbestos
Walls	1	Not Applicable	N/A	Masonry	019	Not Applicable	Not Applicable	A	Yes	0	(-)	0	(-)	0	(-)	SF	V 0000	None
Floor	1	Not Applicable	N/A	Vinyl tiles	008	Not Applicable	Not Applicable	A	Yes	200	(5)	0	(-)	0	(-)	SF	V 9000	Asbestos

Surveyor Notes:

**Location #:** 11

STAFF LUNCH ROOM

**Floor:** 1

**Room Number:** 312 A

**Surveyor**

System	Layer	System Component		Component Material		Component Item	Component Covering	Access	Visible	Condition						Units	Sample Number	Hazard
		Description	Code	Description	Code					Good	Action	Fair	Action	Poor	Action			
Ceiling	1	Patterned pinholes -	AT-001	Glued-on tiles	005	Not Applicable	Not Applicable	C	Yes	300	(-)	0	(-)	0	(-)	SF	V 0000	None
Duct	1	Not Found	N/F	Not Applicable	N/A	Not Applicable	Not Applicable	NI	No	0	(-)	0	(-)	0	(-)	NI	V 0000	None
Floor	1	Not Applicable	N/A	Vinyl tiles	008	Not Applicable	Not Applicable	A	Yes	300	(-)	0	(-)	0	(-)	SF	V 0000	None
Mechanical	1	Not Found	N/F	Not Applicable	N/A	Not Applicable	Not Applicable	NI	No	0	(-)	0	(-)	0	(-)	NI	V 0000	None
Piping	1	Domestic Water (Hot &	DW	Not Insulated	099	Straight	Not Applicable	A	Yes	0	(-)	0	(-)	0	(-)	NI	V 0000	None
Structure	1	Not Found	N/F	Not Applicable	N/A	Not Applicable	Not Applicable	NI	No	0	(-)	0	(-)	0	(-)	NI	V 0000	None

**Legend:**

Access	Condition	Action	Sample Number
A - Accessible To All Building Occupants.	Good - No Visible damage or exposed material.	(-) No Action Required.	S #### Sample Collected.
B - Accessible To Maintenance Staff	Fair - Repairable Damage with minor amounts of exposed material.	(1) Immediate clean-up of debris or damaged ACM likely to be disturbed	V #### Material is visually identified to be identical to S ####.
C - Accessible To Maintenance Staff With a Ladder.	Poor - Irreparable damage with exposed & missing material.	(2) Type 2 precautions for entry into areas with ACM debris	V 0000 Material is visually identified to contain no asbestos.
D - Not Accessible.	Note: Sprayed Materials are only rated as Good or Poor.	(3) ACM removal required	V 9000 Material is visually identified to contain asbestos.
		(4) Type 2 precautions for entry into areas where ACM is present	V 9500 Material is suspected to contain asbestos.
		(5) Proactive ACM removal	Note: Vinyl Tiles, Vinyl sheet Flooring, Drywall, Plaster and Textured Finish (Coat) are considered suspect materials if not sampled.
		(6) Proactive ACM repair	
		(7) Management program and surveillance	
		(8) Suspect Material	

Units : SF - Square Feet LF - Linear Feet EA - Each % - Percentage



**Pinchin Environmental**  
**All Data**

**Project #: 13256**

**Client Name: St. Clair Catholic District School Board**

**Building #: 11**

**Building Name: St. Peter Canisius School Watford**

**Survey Date: 06/12/2010**

**Location #: 11**

**STAFF LUNCH ROOM**

**Floor: 1**

**Room Number: 312 A**

**Surveyor**

(cont'd)

System	Layer	System Component		Component Material		Component Item	Component Covering	Access	Visible	Condition						Units	Sample Number	Hazard
		Description	Code	Description	Code					Good	Action	Fair	Action	Poor	Action			
Walls	1	Not Applicable	N/A	Wood	004	Not Applicable	Not Applicable	A	Yes	0	(-)	0	(-)	0	(-)	SF	V 0000	None
Walls	1	Not Applicable	N/A	Drywall	014	Not Applicable	Not Applicable	A	Yes	100	(7)	0	(-)	0	(-)	%	V 9000	Asbestos
Walls	1	Not Applicable	N/A	Masonry	019	Not Applicable	Not Applicable	A	Yes	0	(-)	0	(-)	0	(-)	SF	V 0000	None
Piping	1	Domestic Water (Hot &	DW	Not Insulated	099	Fitting	Not Applicable	A	Yes	0	(-)	0	(-)	0	(-)	NI	V 0000	None

Surveyor Notes:

**Location #: 12**

**GIRL'S WASHROOM**

**Floor: 1**

**Room Number: 110**

**Surveyor**

System	Layer	System Component		Component Material		Component Item	Component Covering	Access	Visible	Condition						Units	Sample Number	Hazard
		Description	Code	Description	Code					Good	Action	Fair	Action	Poor	Action			
Ceiling	1	Patterned pinholes -	AT-001	Glued-on tiles	005	Not Applicable	Not Applicable	C	No	144	(-)	0	(-)	0	(-)	SF	V 0000	None
Duct	1	Not Found	N/F	Not Applicable	N/A	Not Applicable	Not Applicable	NI	No	0	(-)	0	(-)	0	(-)	NI	V 0000	None
Floor	1	Not Applicable	N/A	Terrazzo	052	Not Applicable	Not Applicable	A	Yes	0	(-)	0	(-)	0	(-)	SF	V 0000	None
Mechanical	1	Not Found	N/F	Not Applicable	N/A	Not Applicable	Not Applicable	NI	No	0	(-)	0	(-)	0	(-)	NI	V 0000	None
Piping	1	Not Applicable	N/A	Not Insulated	099	Not Applicable	Not Applicable	C	No	0	(-)	0	(-)	0	(-)	NI	V 0000	None
Piping	1	Unidentified Pipe	UP	Armaflex	040	Not Applicable	Not Applicable	C	No	0	(-)	0	(-)	0	(-)	NI	V 0000	None

**Legend:**

Access	Condition	Action	Sample Number
A - Accessible To All Building Occupants.	Good - No Visible damage or exposed material.	(-) No Action Required.	S #### Sample Collected.
B - Accessible To Maintenance Staff	Fair - Repairable Damage with minor amounts of exposed material.	(1) Immediate clean-up of debris or damaged ACM likely to be disturbed	V #### Material is visually identified to be identical to S ####.
	Poor - Irreparable damage with exposed & missing material.	(2) Type 2 precautions for entry into areas with ACM debris	V 0000 Material is visually identified to contain no asbestos.
C - Accessible To Maintenance Staff With a Ladder.	Note: Sprayed Materials are only rated as Good or Poor.	(3) ACM removal required	V 9000 Material is visually identified to contain asbestos.
D - Not Accessible.		(4) Type 2 precautions for entry into areas where ACM is present	V 9500 Material is suspected to contain asbestos.
			Note: Vinyl Tiles, Vinyl sheet Flooring, Drywall, Plaster and Textured Finish (Coat) are considered suspect materials if not sampled.

Units : SF - Square Feet LF - Linear Feet EA - Each % - Percentage

**Pinchin Environmental**  
**All Data**

**Project #: 13256**

**Client Name: St. Clair Catholic District School Board**

**Building #: 11**

**Building Name: St. Peter Canisius School Watford**

**Survey Date: 06/12/2010**

**Location #: 12**

**GIRL'S WASHROOM**

**Floor: 1**

**Room Number: 110**

**Surveyor**

(cont'd)

System	Layer	System Component		Component Material		Component Item	Component Covering	Access	Visible	Condition						Units	Sample Number	Hazard
		Description	Code	Description	Code					Good	Action	Fair	Action	Poor	Action			
Structure	1	Not Found	N/F	Not Applicable	N/A	Not Applicable	Not Applicable	NI	No	0	(-)	0	(-)	0	(-)	NI	V 0000	None
Walls	1	Not Applicable	N/A	Masonry	019	Not Applicable	Not Applicable	A	Yes	0	(-)	0	(-)	0	(-)	SF	V 0000	None
Ceiling	1	ACOUSTIC TILE	AT	Lay-in tiles	006	Not Applicable	Not Applicable	C	Yes	NE	(-)	NE	(-)	NE	(-)	NE	V 0000	None
Walls	1	Base	BASE	Drywall	014	Base	Not Applicable	A	Yes	NE	(-)	NE	(-)	NE	(-)	NE	V 0000	None
Piping	1		NE	Aircell	032	Straight		C	No	2	(7)	NE	(-)	NE	(-)	LF	V 9000	Asbestos

Surveyor Notes:

**Location #: 13**

**BOY'S WASHROOM**

**Floor: 1**

**Room Number: 111**

**Surveyor**

System	Layer	System Component		Component Material		Component Item	Component Covering	Access	Visible	Condition						Units	Sample Number	Hazard
		Description	Code	Description	Code					Good	Action	Fair	Action	Poor	Action			
Ceiling	1	Patterned pinholes -	AT-001	Glued-on tiles	005	Not Applicable	Not Applicable	C	Yes	144	(-)	0	(-)	0	(-)	SF	V 0000	None
Duct	1	Not Found	N/F	Not Applicable	N/A	Not Applicable	Not Applicable	NI	No	0	(-)	0	(-)	0	(-)	NI	V 0000	None
Floor	1	Not Applicable	N/A	Terrazzo	052	Not Applicable	Not Applicable	A	Yes	0	(-)	0	(-)	0	(-)	SF	V 0000	None
Mechanical	1	Not Found	N/F	Not Applicable	N/A	Not Applicable	Not Applicable	NI	No	0	(-)	0	(-)	0	(-)	NI	V 0000	None
Piping	1	Not Applicable	N/A	Not Insulated	099	Not Applicable	Not Applicable	C	No	0	(-)	0	(-)	0	(-)	NI	V 0000	None

**Legend:**

Access	Condition	Action	Sample Number
A - Accessible To All Building Occupants.	Good - No Visible damage or exposed material.	(-) No Action Required.	S #### Sample Collected.
B - Accessible To Maintenance Staff	Fair - Repairable Damage with minor amounts of exposed material.	(1) Immediate clean-up of debris or damaged ACM likely to be disturbed	V #### Material is visually identified to be identical to S ####.
	Poor - Irreparable damage with exposed & missing material.	(2) Type 2 precautions for entry into areas with ACM debris	V 0000 Material is visually identified to contain no asbestos.
C - Accessible To Maintenance Staff With a Ladder.	Note: Sprayed Materials are only rated as Good or Poor.	(3) ACM removal required	V 9000 Material is visually identified to contain asbestos.
D - Not Accessible.		(4) Type 2 precautions for entry into areas where ACM is present	V 9500 Material is suspected to contain asbestos.
		(5) Proactive ACM removal	Note: Vinyl Tiles, Vinyl sheet Flooring, Drywall, Plaster and Textured Finish (Coat) are considered suspect materials if not sampled.
		(6) Proactive ACM repair	
		(7) Management program and surveillance	
		(8) Suspect Material	

Units : SF - Square Feet LF - Linear Feet EA - Each % - Percentage

**Pinchin Environmental**  
**All Data**

**Project #: 13256**

**Client Name: St. Clair Catholic District School Board**

**Building #: 11**

**Building Name: St. Peter Canisius School Watford**

**Survey Date: 06/12/2010**

**Location #: 13**

**BOY'S WASHROOM**

**Floor: 1**

**Room Number: 111**

**Surveyor**

(cont'd)

System	Layer	System Component		Component Material		Component Item	Component Covering	Access	Visible	Condition						Units	Sample Number	Hazard
		Description	Code	Description	Code					Good	Action	Fair	Action	Poor	Action			
Piping	1	Unidentified Pipe	UP	Armaflex	040	Not Applicable	Not Applicable	C	No	0	(-)	0	(-)	0	(-)	NI	V 0000	None
Structure	1	Not Found	N/F	Not Applicable	N/A	Not Applicable	Not Applicable	NI	No	0	(-)	0	(-)	0	(-)	NI	V 0000	None
Walls	1	Not Applicable	N/A	Masonry	019	Not Applicable	Not Applicable	A	Yes	0	(-)	0	(-)	0	(-)	SF	V 0000	None
Ceiling	1	ACOUSTIC TILE	AT	Lay-in tiles	006	Not Applicable	Not Applicable	C	Yes	NE	(-)	NE	(-)	NE	(-)	SF	V 0000	None
Walls	1	Base	BASE	Drywall	014	Not Applicable	Not Applicable	A	Yes	NE	(-)	NE	(-)	NE	(-)	SF	V 0000	None

Surveyor Notes:

**Location #: 14**

**PAINT ROOM**

**Floor: 1**

**Room Number: 302 P**

**Surveyor**

System	Layer	System Component		Component Material		Component Item	Component Covering	Access	Visible	Condition						Units	Sample Number	Hazard
		Description	Code	Description	Code					Good	Action	Fair	Action	Poor	Action			
Ceiling	1	Not Applicable	N/A	Drywall	014	Not Applicable	Not Applicable	C	Yes	15	(7)	0	(-)	5	(7)	SF	V 9000	Asbestos
Duct	1	Not Found	N/F	Not Applicable	N/A	Not Applicable	Not Applicable	NI	No	0	(-)	0	(-)	0	(-)	NI	V 0000	None
Floor	1	Not Applicable	N/A	Vinyl tiles	008	Not Applicable	Not Applicable	A	Yes	0	(-)	15	(5)	5	(3)	SF	V 9000	Asbestos
Mechanical	1	Not Found	N/F	Not Applicable	N/A	Not Applicable	Not Applicable	NI	No	0	(-)	0	(-)	0	(-)	NI	V 0000	None
Piping	1	Not Found	N/F	Not Applicable	N/A	Not Applicable	Not Applicable	NI	No	0	(-)	0	(-)	0	(-)	NI	V 0000	None

**Legend:**

Access	Condition	Action	Sample Number
A - Accessible To All Building Occupants.	Good - No Visible damage or exposed material.	(-) No Action Required.	S #### Sample Collected.
B - Accessible To Maintenance Staff	Fair - Repairable Damage with minor amounts of exposed material.	(1) Immediate clean-up of debris or damaged ACM likely to be disturbed	V #### Material is visually identified to be identical to S ####.
	Poor - Irreparable damage with exposed & missing material.	(2) Type 2 precautions for entry into areas with ACM debris	V 0000 Material is visually identified to contain no asbestos.
C - Accessible To Maintenance Staff With a Ladder.	Note: Sprayed Materials are only rated as Good or Poor.	(3) ACM removal required	V 9000 Material is visually identified to contain asbestos.
D - Not Accessible.		(4) Type 2 precautions for entry into areas where ACM is present	V 9500 Material is suspected to contain asbestos.
			Note: Vinyl Tiles, Vinyl sheet Flooring, Drywall, Plaster and Textured Finish (Coat) are considered suspect materials if not sampled.

Units : SF - Square Feet LF - Linear Feet EA - Each % - Percentage

**Pinchin Environmental**  
**All Data**

**Project #:** 13256

**Client Name:** St. Clair Catholic District School Board

**Building #:** 11

**Building Name:** St. Peter Canisius School Watford

**Survey Date:** 06/12/2010

**Location #:** 14

PAINT ROOM

**Floor:** 1

**Room Number:** 302 P

**Surveyor**

(cont'd)

System	Layer	System Component		Component Material		Component Item	Component Covering	Access	Visible	Condition						Units	Sample Number	Hazard
		Description	Code	Description	Code					Good	Action	Fair	Action	Poor	Action			
Structure	1	Not Found	N/F	Not Applicable	N/A	Not Applicable	Not Applicable	NI	No	0	(-)	0	(-)	0	(-)	NI	V 0000	None
Walls	1	Not Applicable	N/A	Masonry	019	Not Applicable	Not Applicable	A	Yes	0	(-)	0	(-)	0	(-)	SF	V 0000	None

Surveyor Notes:

**Location #:** 15

STORAGE CLOSET

**Floor:** 1

**Room Number:** 303 P

**Surveyor**

System	Layer	System Component		Component Material		Component Item	Component Covering	Access	Visible	Condition						Units	Sample Number	Hazard
		Description	Code	Description	Code					Good	Action	Fair	Action	Poor	Action			
Ceiling	1	Not Applicable	N/A	Drywall	014	Not Applicable	Not Applicable	C	Yes	10	(7)	0	(-)	0	(-)	SF	V 9000	Asbestos
Duct	1	Not Found	N/F	Not Applicable	N/A	Not Applicable	Not Applicable	NI	No	0	(-)	0	(-)	0	(-)	NI	V 0000	None
Floor	1	Not Applicable	N/A	Vinyl tiles	008	Not Applicable	Not Applicable	A	Yes	8	(7)	0	(-)	2	(7)	SF	V 9000	Asbestos
Mechanical	1	Not Found	N/F	Not Applicable	N/A	Not Applicable	Not Applicable	NI	No	0	(-)	0	(-)	0	(-)	NI	V 0000	None
Piping	1	Not Found	N/F	Not Applicable	N/A	Not Applicable	Not Applicable	NI	No	0	(-)	0	(-)	0	(-)	NI	V 0000	None
Structure	1	Not Found	N/F	Not Applicable	N/A	Not Applicable	Not Applicable	NI	No	0	(-)	0	(-)	0	(-)	NI	V 0000	None
Walls	1	Not Applicable	N/A	Masonry	019	Not Applicable	Not Applicable	A	Yes	0	(-)	0	(-)	0	(-)	SF	V 0000	None

**Legend:**

Access	Condition	Action	Sample Number
A - Accessible To All Building Occupants.	Good - No Visible damage or exposed material.	(-) No Action Required.	S #### Sample Collected.
B - Accessible To Maintenance Staff	Fair - Repairable Damage with minor amounts of exposed material.	(1) Immediate clean-up of debris or damaged ACM likely to be disturbed	V #### Material is visually identified to be identical to S ####.
	Poor - Irreparable damage with exposed & missing material.	(2) Type 2 precautions for entry into areas with ACM debris	V 0000 Material is visually identified to contain no asbestos.
C - Accessible To Maintenance Staff With a Ladder.	Note: Sprayed Materials are only rated as Good or Poor.	(3) ACM removal required	V 9000 Material is visually identified to contain asbestos.
D - Not Accessible.		(4) Type 2 precautions for entry into areas where ACM is present	V 9500 Material is suspected to contain asbestos.
			Note: Vinyl Tiles, Vinyl sheet Flooring, Drywall, Plaster and Textured Finish (Coat) are considered suspect materials if not sampled.

Units : SF - Square Feet LF - Linear Feet EA - Each % - Percentage

**Pinchin Environmental**  
**All Data**

**Project #:** 13256

**Client Name:** St. Clair Catholic District School Board

**Building #:** 11

**Building Name:** St. Peter Canisius School Watford

**Survey Date:** 06/12/2010

Surveyor Notes:

**Location #:** 16

**STORAGE CLOSET**

**Floor:** 1

**Room Number:** 306 P

**Surveyor**

System	Layer	System Component		Component Material		Component Item	Component Covering	Access	Visible	Condition						Units	Sample Number	Hazard
		Description	Code	Description	Code					Good	Action	Fair	Action	Poor	Action			
Ceiling	1	Not Applicable	N/A	Drywall	014	Not Applicable	Not Applicable	C	Yes	20	(7)	0	(-)	0	(-)	SF	V 9000	Asbestos
Duct	1	Not Found	N/F	Not Applicable	N/A	Not Applicable	Not Applicable	NI	No	0	(-)	0	(-)	0	(-)	NI	V 0000	None
Floor	1	Not Applicable	N/A	Vinyl tiles	008	Not Applicable	Not Applicable	A	Yes	20	(7)	0	(-)	0	(-)	SF	V 9000	Asbestos
Mechanical	1	Not Found	N/F	Not Applicable	N/A	Not Applicable	Not Applicable	NI	No	0	(-)	0	(-)	0	(-)	NI	V 0000	None
Piping	1	Not Found	N/F	Not Applicable	N/A	Not Applicable	Not Applicable	NI	No	0	(-)	0	(-)	0	(-)	NI	V 0000	None
Structure	1	Not Found	N/F	Not Applicable	N/A	Not Applicable	Not Applicable	NI	No	0	(-)	0	(-)	0	(-)	NI	V 0000	None
Walls	1	Not Applicable	N/A	Masonry	019	Not Applicable	Not Applicable	A	Yes	0	(-)	0	(-)	0	(-)	SF	V 0000	None

Surveyor Notes:

**Legend:**

Access	Condition	Action	Sample Number
A - Accessible To All Building Occupants.	Good - No Visible damage or exposed material.	(-) No Action Required.	S #### Sample Collected.
B - Accessible To Maintenance Staff	Fair - Repairable Damage with minor amounts of exposed material.	(1) Immediate clean-up of debris or damaged ACM likely to be disturbed	V #### Material is visually identified to be identical to S ####.
	Poor - Irreparable damage with exposed & missing material.	(2) Type 2 precautions for entry into areas with ACM debris	V 0000 Material is visually identified to contain no asbestos.
C - Accessible To Maintenance Staff With a Ladder.	Note: Sprayed Materials are only rated as Good or Poor.	(3) ACM removal required	V 9000 Material is visually identified to contain asbestos.
D - Not Accessible.		(4) Type 2 precautions for entry into areas where ACM is present	V 9500 Material is suspected to contain asbestos.
		(5) Proactive ACM removal	Note: Vinyl Tiles, Vinyl sheet Flooring, Drywall, Plaster and Textured Finish (Coat) are considered suspect materials if not sampled.
		(6) Proactive ACM repair	
		(7) Management program and surveillance	
		(8) Suspect Material	

Units : SF - Square Feet LF - Linear Feet EA - Each % - Percentage

**Pinchin Environmental**  
**All Data**

**Project #:** 13256

**Client Name:** St. Clair Catholic District School Board

**Building #:** 11

**Building Name:** St. Peter Canisius School Watford

**Survey Date:** 06/12/2010

**Location #:** 17

STORAGE CLOSET

**Floor:** 1

**Room Number:** 307 P

**Surveyor**

System	Layer	System Component		Component Material		Component Item	Component Covering	Access	Visible	Condition						Units	Sample Number	Hazard
		Description	Code	Description	Code					Good	Action	Fair	Action	Poor	Action			
Ceiling	1	Not Applicable	N/A	Drywall	014	Not Applicable	Not Applicable	C	Yes	20	(7)	0	(-)	0	(-)	SF	V 9000	Asbestos
Duct	1	Not Found	N/F	Not Applicable	N/A	Not Applicable	Not Applicable	NI	No	0	(-)	0	(-)	0	(-)	NI	V 0000	None
Floor	1	Not Applicable	N/A	Vinyl tiles	008	Not Applicable	Not Applicable	A	Yes	20	(7)	0	(-)	0	(-)	SF	V 9000	Asbestos
Mechanical	1	Not Found	N/F	Not Applicable	N/A	Not Applicable	Not Applicable	NI	No	0	(-)	0	(-)	0	(-)	NI	V 0000	None
Piping	1	Not Found	N/F	Not Applicable	N/A	Not Applicable	Not Applicable	NI	No	0	(-)	0	(-)	0	(-)	NI	V 0000	None
Structure	1	Not Found	N/F	Not Applicable	N/A	Not Applicable	Not Applicable	NI	No	0	(-)	0	(-)	0	(-)	NI	V 0000	None
Walls	1	Not Applicable	N/A	Masonry	019	Not Applicable	Not Applicable	A	Yes	0	(-)	0	(-)	0	(-)	SF	V 0000	None

Surveyor Notes:

**Location #:** 18

GIRL'S WASHROOM

**Floor:** 1

**Room Number:** 112

**Surveyor**

System	Layer	System Component		Component Material		Component Item	Component Covering	Access	Visible	Condition						Units	Sample Number	Hazard
		Description	Code	Description	Code					Good	Action	Fair	Action	Poor	Action			
Ceiling	1	Not Applicable	N/A	Drywall	014	Not Applicable	Not Applicable	C	Yes	144	(7)	0	(-)	0	(-)	SF	V 9000	Asbestos
Duct	1	Not Found	N/F	Not Applicable	N/A	Not Applicable	Not Applicable	NI	No	0	(-)	0	(-)	0	(-)	NI	V 0000	None
Floor	1	Not Applicable	N/A	Terrazzo	052	Not Applicable	Not Applicable	A	Yes	0	(-)	0	(-)	0	(-)	SF	V 0000	None

**Legend:**

Access	Condition	Action	Sample Number
A - Accessible To All Building Occupants.	Good - No Visible damage or exposed material.	(-) No Action Required.	S #### Sample Collected.
B - Accessible To Maintenance Staff	Fair - Repairable Damage with minor amounts of exposed material.	(1) Immediate clean-up of debris or damaged ACM likely to be disturbed	V #### Material is visually identified to be identical to S ####.
	Poor - Irreparable damage with exposed & missing material.	(2) Type 2 precautions for entry into areas with ACM debris	V 0000 Material is visually identified to contain no asbestos.
C - Accessible To Maintenance Staff With a Ladder.	Note: Sprayed Materials are only rated as Good or Poor.	(3) ACM removal required	V 9000 Material is visually identified to contain asbestos.
D - Not Accessible.		(4) Type 2 precautions for entry into areas where ACM is present	V 9500 Material is suspected to contain asbestos.
			Note: Vinyl Tiles, Vinyl sheet Flooring, Drywall, Plaster and Textured Finish (Coat) are considered suspect materials if not sampled.

Units : SF - Square Feet LF - Linear Feet EA - Each % - Percentage

**Pinchin Environmental**  
**All Data**

**Project #: 13256**

**Client Name: St. Clair Catholic District School Board**

**Building #: 11**

**Building Name: St. Peter Canisius School Watford**

**Survey Date: 06/12/2010**

**Location #: 18**

**GIRL'S WASHROOM**

**Floor: 1**

**Room Number: 112**

**Surveyor**

(cont'd)

System	Layer	System Component		Component Material		Component Item	Component Covering	Access	Visible	Condition						Units	Sample Number	Hazard
		Description	Code	Description	Code					Good	Action	Fair	Action	Poor	Action			
Mechanical	1	Not Found	N/F	Not Applicable	N/A	Not Applicable	Not Applicable	NI	No	0	(-)	0	(-)	0	(-)	NI	V 0000	None
Piping	1	Not Found	N/F	Not Applicable	N/A	Not Applicable	Not Applicable	NI	No	0	(-)	0	(-)	0	(-)	NI	V 0000	None
Structure	1	Not Found	N/F	Not Applicable	N/A	Not Applicable	Not Applicable	NI	No	0	(-)	0	(-)	0	(-)	NI	V 0000	None
Walls	1	Not Applicable	N/A	Masonry	019	Not Applicable	Not Applicable	A	Yes	0	(-)	0	(-)	0	(-)	SF	V 0000	None

Surveyor Notes:

**Location #: 19**

**BOY'S WASHROOM**

**Floor: 1**

**Room Number: 113**

**Surveyor**

System	Layer	System Component		Component Material		Component Item	Component Covering	Access	Visible	Condition						Units	Sample Number	Hazard
		Description	Code	Description	Code					Good	Action	Fair	Action	Poor	Action			
Ceiling	1	Not Applicable	N/A	Lay-in tiles	006	Not Applicable	Not Applicable	C	Yes	144	(-)	0	(-)	0	(-)	SF	N NE	None
Duct	1	Not Found	N/F	Not Applicable	N/A	Not Applicable	Not Applicable	NI	No	0	(-)	0	(-)	0	(-)	NI	V 0000	None
Floor	1	Not Applicable	N/A	Terrazzo	052	Not Applicable	Not Applicable	A	Yes	0	(-)	0	(-)	0	(-)	SF	V 0000	None
Mechanical	1	Not Found	N/F	Not Applicable	N/A	Not Applicable	Not Applicable	NI	No	0	(-)	0	(-)	0	(-)	NI	V 0000	None
Piping	1	Not Found	N/F	Not Applicable	N/A	Not Applicable	Not Applicable	NI	No	0	(-)	0	(-)	0	(-)	NI	V 0000	None
Structure	1	Not Found	N/F	Not Applicable	N/A	Not Applicable	Not Applicable	NI	No	0	(-)	0	(-)	0	(-)	NI	V 0000	None

**Legend:**

Access	Condition	Action	Sample Number
A - Accessible To All Building Occupants.	Good - No Visible damage or exposed material.	(-) No Action Required.	S #### Sample Collected.
B - Accessible To Maintenance Staff	Fair - Repairable Damage with minor amounts of exposed material.	(1) Immediate clean-up of debris or damaged ACM likely to be disturbed	V #### Material is visually identified to be identical to S ####.
C - Accessible To Maintenance Staff With a Ladder.	Poor - Irreparable damage with exposed & missing material.	(2) Type 2 precautions for entry into areas with ACM debris	V 0000 Material is visually identified to contain asbestos.
D - Not Accessible.	Note: Sprayed Materials are only rated as Good or Poor.	(3) ACM removal required	V 9000 Material is visually identified to contain asbestos.
		(4) Type 2 precautions for entry into areas where ACM is present	V 9500 Material is suspected to contain asbestos.
		(5) Proactive ACM removal	Note: Vinyl Tiles, Vinyl sheet Flooring, Drywall, Plaster and Textured Finish (Coat) are considered suspect materials if not sampled.
		(6) Proactive ACM repair	
		(7) Management program and surveillance	
		(8) Suspect Material	

Units : SF - Square Feet LF - Linear Feet EA - Each % - Percentage

**Pinchin Environmental**  
**All Data**

**Project #: 13256**

**Client Name: St. Clair Catholic District School Board**

**Building #: 11**

**Building Name: St. Peter Canisius School Watford**

**Survey Date: 06/12/2010**

**Location #: 19**

**BOY'S WASHROOM**

**Floor: 1**

**Room Number: 113**

**Surveyor**

(cont'd)

System	Layer	System Component		Component Material		Component Item	Component Covering	Access	Visible	Condition						Units	Sample Number	Hazard
		Description	Code	Description	Code					Good	Action	Fair	Action	Poor	Action			
Walls	1	Not Applicable	N/A	Masonry	019	Not Applicable	Not Applicable	A	Yes	0	(-)	0	(-)	0	(-)	SF	V 0000	None

Surveyor Notes:

**Location #: 20**

**GYMNASIUM**

**Floor: 1**

**Room Number: 108 A**

**Surveyor**

System	Layer	System Component		Component Material		Component Item	Component Covering	Access	Visible	Condition						Units	Sample Number	Hazard
		Description	Code	Description	Code					Good	Action	Fair	Action	Poor	Action			
Ceiling	1	Not Applicable	N/A	Not Applicable	N/A	Not Applicable	Not Applicable	C	Yes	0	(-)	0	(-)	0	(-)	SF	V 0000	None
Duct	1	Not Applicable	N/A	Not Insulated	099	Not Applicable	Not Applicable	C	Yes	0	(-)	0	(-)	0	(-)	NI	V 0000	None
Floor	1	Not Applicable	N/A	Vinyl tiles	008	Not Applicable	Not Applicable	A	Yes	1500	(7)	0	(-)	0	(-)	SF	V 9000	Asbestos
Mechanical	1	Not Found	N/F	Not Applicable	N/A	Not Applicable	Not Applicable	NI	No	0	(-)	0	(-)	0	(-)	NI	V 0000	None
Piping	1	Not Found	N/F	Not Applicable	N/A	Not Applicable	Not Applicable	NI	No	0	(-)	0	(-)	0	(-)	NI	V 0000	None
Structure	1	Deck	DCK	Steel	001	Not Applicable	Not Applicable	C	Yes	0	(-)	0	(-)	0	(-)	NI	V 0000	None
Structure	1	Joist	JST	Steel	001	Not Applicable	Not Applicable	C	Yes	0	(-)	0	(-)	0	(-)	NI	V 0000	None
Walls	1	Not Applicable	N/A	Masonry	019	Not Applicable	Not Applicable	A	Yes	0	(-)	0	(-)	0	(-)	SF	V 0000	None

**Legend:**

Access	Condition	Action	Sample Number
A - Accessible To All Building Occupants.	Good - No Visible damage or exposed material.	(-) No Action Required.	S #### Sample Collected.
B - Accessible To Maintenance Staff	Fair - Repairable Damage with minor amounts of exposed material.	(1) Immediate clean-up of debris or damaged ACM likely to be disturbed	V #### Material is visually identified to be identical to S ####.
	Poor - Irreparable damage with exposed & missing material.	(2) Type 2 precautions for entry into areas with ACM debris	V 0000 Material is visually identified to contain no asbestos.
C - Accessible To Maintenance Staff With a Ladder.	Note: Sprayed Materials are only rated as Good or Poor.	(3) ACM removal required	V 9000 Material is visually identified to contain asbestos.
D - Not Accessible.		(4) Type 2 precautions for entry into areas where ACM is present	V 9500 Material is suspected to contain asbestos.
		(5) Proactive ACM removal	Note: Vinyl Tiles, Vinyl sheet Flooring, Drywall, Plaster and Textured Finish (Coat) are considered suspect materials if not sampled.
		(6) Proactive ACM repair	
		(7) Management program and surveillance	
		(8) Suspect Material	

Units : SF - Square Feet LF - Linear Feet EA - Each % - Percentage



**Pinchin Environmental**  
**All Data**

**Project #:** 13256

**Client Name:** St. Clair Catholic District School Board

**Building #:** 11

**Building Name:** St. Peter Canisius School Watford

**Survey Date:** 06/12/2010

Surveyor Notes: MERCURY THERMOSTAT IS PRESENT AT THIS LOCATION.

**Location #:** 21

**EQUIPMENT STORAGE**

**Floor:** 1

**Room Number:** 310 P

**Surveyor**

System	Layer	System Component		Component Material		Component Item	Component Covering	Access	Visible	Condition						Units	Sample Number	Hazard
		Description	Code	Description	Code					Good	Action	Fair	Action	Poor	Action			
Ceiling	1	Not Applicable	N/A	Drywall	014	Not Applicable	Not Applicable	C	Yes	250	(7)	0	(-)	0	(-)	SF	V 9000	Asbestos
Duct	1	Not Found	N/F	Not Applicable	N/A	Not Applicable	Not Applicable	NI	No	0	(-)	0	(-)	0	(-)	NI	V 0000	None
Floor	1	Not Applicable	N/A	Vinyl tiles	008	Not Applicable	Not Applicable	A	Yes	250	(7)	0	(-)	0	(-)	SF	V 9000	Asbestos
Mechanical	1	Not Applicable	N/A	Not Applicable	N/A	Not Applicable	Not Applicable	NI	No	0	(-)	0	(-)	0	(-)	NI	V 0000	None
Piping	1	Unidentified Pipe	UP	Fibreglass	028	Straight	Cheesecloth	A	Yes	0	(-)	0	(-)	0	(-)	NI	V 0000	None
Structure	1	Not Found	N/F	Not Applicable	N/A	Not Applicable	Not Applicable	NI	No	0	(-)	0	(-)	0	(-)	NI	V 0000	None
Walls	1	Not Applicable	N/A	Masonry	019	Not Applicable	Not Applicable	A	Yes	0	(-)	0	(-)	0	(-)	SF	V 0000	None
Other	1	Debris (Fallen)	DBRS	Thermal	029			A	Yes	0	(-)	0	(-)	1	(-)	SF	S 0014	None

Surveyor Notes:

**Legend:**

Access	Condition	Action	Sample Number
A - Accessible To All Building Occupants.	Good - No Visible damage or exposed material.	(-) No Action Required.	S #### Sample Collected.
B - Accessible To Maintenance Staff	Fair - Repairable Damage with minor amounts of exposed material.	(1) Immediate clean-up of debris or damaged ACM likely to be disturbed	V #### Material is visually identified to be identical to S ####.
C - Accessible To Maintenance Staff With a Ladder.	Poor - Irreparable damage with exposed & missing material.	(2) Type 2 precautions for entry into areas with ACM debris	V 0000 Material is visually identified to contain no asbestos.
D - Not Accessible.	Note: Sprayed Materials are only rated as Good or Poor.	(3) ACM removal required	V 9000 Material is visually identified to contain asbestos.
		(4) Type 2 precautions for entry into areas where ACM is present	V 9500 Material is suspected to contain asbestos.
		(5) Proactive ACM removal	Note: Vinyl Tiles, Vinyl sheet Flooring, Drywall, Plaster and Textured Finish (Coat) are considered suspect materials if not sampled.
		(6) Proactive ACM repair	
		(7) Management program and surveillance	
		(8) Suspect Material	

Units : SF - Square Feet LF - Linear Feet EA - Each % - Percentage

**Pinchin Environmental**  
**All Data**

**Project #:** 13256

**Client Name:** St. Clair Catholic District School Board

**Building #:** 11

**Building Name:** St. Peter Canisius School Watford

**Survey Date:** 06/12/2010

**Location #:** 22

**WOMEN'S STAFF WASHROOM**

**Floor:** 1

**Room Number:** 315 P

**Surveyor**

System	Layer	System Component		Component Material		Component Item	Component Covering	Access	Visible	Condition						Units	Sample Number	Hazard
		Description	Code	Description	Code					Good	Action	Fair	Action	Poor	Action			
Ceiling	1	Not Applicable	N/A	Drywall	014	Not Applicable	Not Applicable	C	Yes	30	(7)	0	(-)	0	(-)	SF	V 9000	Asbestos
Duct	1	Not Found	N/F	Not Applicable	N/A	Not Applicable	Not Applicable	NI	No	0	(-)	0	(-)	0	(-)	NI	V 0000	None
Floor	1	Not Applicable	N/A	Vinyl sheet	009	Not Applicable	Not Applicable	A	Yes	30	(-)	0	(-)	0	(-)	SF	V 0002	None
Mechanical	1	Not Found	N/F	Not Applicable	N/A	Not Applicable	Not Applicable	NI	No	0	(-)	0	(-)	0	(-)	NI	V 0000	None
Piping	1	Not Found	N/F	Not Applicable	N/A	Not Applicable	Not Applicable	NI	No	0	(-)	0	(-)	0	(-)	NI	V 0000	None
Structure	1	Not Found	N/F	Not Applicable	N/A	Not Applicable	Not Applicable	NI	No	0	(-)	0	(-)	0	(-)	NI	V 0000	None
Walls	1	Not Applicable	N/A	Masonry	019	Not Applicable	Not Applicable	A	Yes	0	(-)	0	(-)	0	(-)	SF	V 0000	None

Surveyor Notes:

**Location #:** 23

**MEN'S STAFF WASHROOM**

**Floor:** 1

**Room Number:** 316 P

**Surveyor**

System	Layer	System Component		Component Material		Component Item	Component Covering	Access	Visible	Condition						Units	Sample Number	Hazard
		Description	Code	Description	Code					Good	Action	Fair	Action	Poor	Action			
Ceiling	1	Not Applicable	N/A	Drywall	014	Not Applicable	Not Applicable	C	Yes	30	(7)	0	(-)	0	(-)	SF	V 9000	Asbestos
Duct	1	Not Found	N/F	Not Applicable	N/A	Not Applicable	Not Applicable	NI	No	0	(-)	0	(-)	0	(-)	NI	V 0000	None
Floor	1	Not Applicable	N/A	Vinyl sheet	009	Not Applicable	Not Applicable	A	Yes	30	(-)	0	(-)	0	(-)	SF	V 0002	None

**Legend:**

Access	Condition	Action	Sample Number
A - Accessible To All Building Occupants.	Good - No Visible damage or exposed material.	(-) No Action Required.	S #### Sample Collected.
B - Accessible To Maintenance Staff	Fair - Repairable Damage with minor amounts of exposed material.	(1) Immediate clean-up of debris or damaged ACM likely to be disturbed	V #### Material is visually identified to be identical to S ####.
C - Accessible To Maintenance Staff With a Ladder.	Poor - Irreparable damage with exposed & missing material.	(2) Type 2 precautions for entry into areas with ACM debris	V 0000 Material is visually identified to contain no asbestos.
D - Not Accessible.	Note: Sprayed Materials are only rated as Good or Poor.	(3) ACM removal required	V 9000 Material is visually identified to contain asbestos.
		(4) Type 2 precautions for entry into areas where ACM is present	V 9500 Material is suspected to contain asbestos.
		(5) Proactive ACM removal	Note: Vinyl Tiles, Vinyl sheet Flooring, Drywall, Plaster and Textured Finish (Coat) are considered suspect materials if not sampled.
		(6) Proactive ACM repair	
		(7) Management program and surveillance	
		(8) Suspect Material	

Units : SF - Square Feet LF - Linear Feet EA - Each % - Percentage

**Pinchin Environmental**  
**All Data**

**Project #: 13256**

**Client Name: St. Clair Catholic District School Board**

**Building #: 11**

**Building Name: St. Peter Canisius School Watford**

**Survey Date: 06/12/2010**

**Location #: 23**

**MEN'S STAFF WASHROOM**

**Floor: 1**

**Room Number: 316 P**

**Surveyor**

(cont'd)

System	Layer	System Component		Component Material		Component Item	Component Covering	Access	Visible	Condition						Units	Sample Number	Hazard
		Description	Code	Description	Code					Good	Action	Fair	Action	Poor	Action			
Mechanical	1	Not Found	N/F	Not Applicable	N/A	Not Applicable	Not Applicable	NI	No	0	(-)	0	(-)	0	(-)	NI	V 0000	None
Piping	1	Not Found	N/F	Not Applicable	N/A	Not Applicable	Not Applicable	NI	No	0	(-)	0	(-)	0	(-)	NI	V 0000	None
Structure	1	Not Found	N/F	Not Applicable	N/A	Not Applicable	Not Applicable	NI	No	0	(-)	0	(-)	0	(-)	NI	V 0000	None
Walls	1	Not Applicable	N/A	Masonry	019	Not Applicable	Not Applicable	A	Yes	0	(-)	0	(-)	0	(-)	SF	V 0000	None

Surveyor Notes:

**Location #: 24**

**FRENCH ROOM**

**Floor: 1**

**Room Number: 313 P**

**Surveyor**

System	Layer	System Component		Component Material		Component Item	Component Covering	Access	Visible	Condition						Units	Sample Number	Hazard
		Description	Code	Description	Code					Good	Action	Fair	Action	Poor	Action			
Ceiling one	1	Not Applicable	N/A	Drywall	014	Not Applicable	Not Applicable	C	No	240	(7)	0	(-)	0	(-)	SF	V 9000	Asbestos
Ceiling	1	ACOUSTIC TILE	AT	Lay-in tiles	006	Not Applicable	Not Applicable	C	Yes	240	(-)	0	(-)	0	(-)	SF	V 0000	None
Duct	1	Not Found	N/F	Not Applicable	N/A	Not Applicable	Not Applicable	NI	No	0	(-)	0	(-)	0	(-)	NI	V 0000	None
Floor	1	Not Applicable	N/A	Carpet	050	Not Applicable	Not Applicable	A	Yes	0	(-)	0	(-)	0	(-)	SF	V 0000	None
Mechanical	1	Not Found	N/F	Not Applicable	N/A	Not Applicable	Not Applicable	NI	No	0	(-)	0	(-)	0	(-)	NI	V 0000	None
Piping	1	Hot Water Heating	HWH	Fibreglass	028	Straight	Cheesecloth	A	Yes	0	(-)	0	(-)	0	(-)	NI	V 0000	None

**Legend:**

Access	Condition	Action	Sample Number
A - Accessible To All Building Occupants.	Good - No Visible damage or exposed material.	(-) No Action Required.	S #### Sample Collected.
B - Accessible To Maintenance Staff	Fair - Repairable Damage with minor amounts of exposed material.	(1) Immediate clean-up of debris or damaged ACM likely to be disturbed	V #### Material is visually identified to be identical to S ####.
	Poor - Irreparable damage with exposed & missing material.	(2) Type 2 precautions for entry into areas with ACM debris	V 0000 Material is visually identified to contain asbestos.
C - Accessible To Maintenance Staff With a Ladder.	Note: Sprayed Materials are only rated as Good or Poor.	(3) ACM removal required	V 9000 Material is visually identified to contain asbestos.
D - Not Accessible.		(4) Type 2 precautions for entry into areas where ACM is present	V 9500 Material is suspected to contain asbestos.
		(5) Proactive ACM removal	Note: Vinyl Tiles, Vinyl sheet Flooring, Drywall, Plaster and Textured Finish (Coat) are considered suspect materials if not sampled.
		(6) Proactive ACM repair	
		(7) Management program and surveillance	
		(8) Suspect Material	

Units : SF - Square Feet LF - Linear Feet EA - Each % - Percentage

**Pinchin Environmental**  
**All Data**

**Project #: 13256**

**Client Name: St. Clair Catholic District School Board**

**Building #: 11**

**Building Name: St. Peter Canisius School Watford**

**Survey Date: 06/12/2010**

**Location #: 24**

**FRENCH ROOM**

**Floor: 1**

**Room Number: 313 P**

**Surveyor**

(cont'd)

System	Layer	System Component		Component Material		Component Item	Component Covering	Access	Visible	Condition						Units	Sample Number	Hazard
		Description	Code	Description	Code					Good	Action	Fair	Action	Poor	Action			
Structure	1	Not Found	N/F	Not Applicable	N/A	Not Applicable	Not Applicable	NI	No	0	(-)	0	(-)	0	(-)	NI	V 0000	None
Walls	1	Not Applicable	N/A	Wood	004	Not Applicable	Not Applicable	A	Yes	0	(-)	0	(-)	0	(-)	SF	V 0000	None
Walls	1	Not Applicable	N/A	Drywall	014	Not Applicable	Not Applicable	A	Yes	100	(7)	0	(-)	0	(-)	%	V 9000	Asbestos
Walls	1	Not Applicable	N/A	Masonry	019	Not Applicable	Not Applicable	A	Yes	0	(-)	0	(-)	0	(-)	SF	V 0000	None
Other	1	Debris (Fallen)	DBRS	Thermal	029			A	Yes	0	(-)	0	(-)	0	(-)	SF	V 0014	None

Surveyor Notes:

**Location #: 25**

**CLASSROOM**

**Floor: 1**

**Room Number: 107 A**

**Surveyor**

System	Layer	System Component		Component Material		Component Item	Component Covering	Access	Visible	Condition						Units	Sample Number	Hazard
		Description	Code	Description	Code					Good	Action	Fair	Action	Poor	Action			
Ceiling	1	Patterned pinholes -	AT-001	Glued-on tiles	005	Not Applicable	Not Applicable	C	Yes	600	(-)	0	(-)	0	(-)	SF	V 0000	None
Duct	1	All	ALL	Not Insulated	099	Not Applicable	Not Applicable	NI	No	0	(-)	0	(-)	0	(-)	NI	V 0000	None
Mechanical	1	Not Found	N/F	Not Applicable	N/A	Not Applicable	Not Applicable	NI	No	0	(-)	0	(-)	0	(-)	NI	V 0000	None
Piping	1	Not Found	N/F	Not Applicable	N/A	Not Applicable	Not Applicable	NI	No	0	(-)	0	(-)	0	(-)	NI	V 0000	None
Structure	1	Not Found	N/F	Not Applicable	N/A	Not Applicable	Not Applicable	NI	No	0	(-)	0	(-)	0	(-)	NI	V 0000	None

**Legend:**

Access	Condition	Action	Sample Number
A - Accessible To All Building Occupants.	Good - No Visible damage or exposed material.	(-) No Action Required.	S #### Sample Collected.
B - Accessible To Maintenance Staff	Fair - Repairable Damage with minor amounts of exposed material.	(1) Immediate clean-up of debris or damaged ACM likely to be disturbed	V #### Material is visually identified to be identical to S ####.
C - Accessible To Maintenance Staff With a Ladder.	Poor - Irreparable damage with exposed & missing material.	(2) Type 2 precautions for entry into areas with ACM debris	V 0000 Material is visually identified to contain no asbestos.
D - Not Accessible.	Note: Sprayed Materials are only rated as Good or Poor.	(3) ACM removal required	V 9000 Material is visually identified to contain asbestos.
		(4) Type 2 precautions for entry into areas where ACM is present	V 9500 Material is suspected to contain asbestos.
		(5) Proactive ACM removal	Note: Vinyl Tiles, Vinyl sheet Flooring, Drywall, Plaster and Textured Finish (Coat) are considered suspect materials if not sampled.
		(6) Proactive ACM repair	
		(7) Management program and surveillance	
		(8) Suspect Material	

Units : SF - Square Feet LF - Linear Feet EA - Each % - Percentage

**Pinchin Environmental**  
**All Data**

**Project #: 13256**

**Client Name: St. Clair Catholic District School Board**

**Building #: 11**

**Building Name: St. Peter Canisius School Watford**

**Survey Date: 06/12/2010**

**Location #: 25**

**CLASSROOM**

**Floor: 1**

**Room Number: 107 A**

**Surveyor**

(cont'd)

System	Layer	System Component		Component Material		Component Item	Component Covering	Access	Visible	Condition						Units	Sample Number	Hazard
		Description	Code	Description	Code					Good	Action	Fair	Action	Poor	Action			
Walls	1	Not Applicable	N/A	Drywall	014	Not Applicable	Not Applicable	A	Yes	100	(7)	0	(-)	0	(-)	%	V 9000	Asbestos
Walls	1	Not Applicable	N/A	Masonry	019	Not Applicable	Not Applicable	A	Yes	0	(-)	0	(-)	0	(-)	SF	V 0000	None
Ceiling	1	ACOUSTIC TILE	AT	Lay-in tiles	006	Not Applicable	Not Applicable	C	Yes	NE	(-)	NE	(-)	NE	(-)	%	V 0000	None

Surveyor Notes: MERCURY THERMOSTAT IS PRESENT AT THIS LOCATION.

**Location #: 26**

**CORRIDOR**

**Floor: 1**

**Room Number:**

**Surveyor**

System	Layer	System Component		Component Material		Component Item	Component Covering	Access	Visible	Condition						Units	Sample Number	Hazard
		Description	Code	Description	Code					Good	Action	Fair	Action	Poor	Action			
Ceiling	1	Patterned pinholes	AT-005	Lay-in tiles	006	Not Applicable	Not Applicable	C	Yes	320	(-)	0	(-)	0	(-)	SF	S 0007	None
Duct	1	Not Applicable	N/A	Not Insulated	099	Not Applicable	Not Applicable	C	No	0	(-)	0	(-)	0	(-)	NI	V 0000	None
Floor	1	Not Applicable	N/A	Terrazzo	052	Not Applicable	Not Applicable	A	Yes	0	(-)	0	(-)	0	(-)	SF	V 0000	None
Mechanical	1	Not Applicable	N/A	Not Applicable	N/A	Not Applicable	Not Applicable	NI	No	0	(-)	0	(-)	0	(-)	NI	V 0000	None
Piping	1	Unidentified Pipe	UP	Parging Cement	031	Fitting	Cheesecloth	C	No	40	(7)	0	(-)	0	(-)	EA	V 0001	Asbestos
Piping	1	Unidentified Pipe	UP	Fibreglass	028	Straight	Not Applicable	C	No	0	(-)	0	(-)	0	(-)	NI	V 0000	None
Structure	1	Not Applicable	N/A	Wood	004	Not Applicable	Not Applicable	C	No	0	(-)	0	(-)	0	(-)	NI	V 0000	None

**Legend:**

Access	Condition	Action	Sample Number
A - Accessible To All Building Occupants.	Good - No Visible damage or exposed material.	(-) No Action Required.	S #### Sample Collected.
B - Accessible To Maintenance Staff	Fair - Repairable Damage with minor amounts of exposed material.	(1) Immediate clean-up of debris or damaged ACM likely to be disturbed	V #### Material is visually identified to be identical to S ####.
	Poor - Irreparable damage with exposed & missing material.	(2) Type 2 precautions for entry into areas with ACM debris	V 0000 Material is visually identified to contain no asbestos.
C - Accessible To Maintenance Staff With a Ladder.	Note: Sprayed Materials are only rated as Good or Poor.	(3) ACM removal required	V 9000 Material is visually identified to contain asbestos.
D - Not Accessible.		(4) Type 2 precautions for entry into areas where ACM is present	V 9500 Material is suspected to contain asbestos.
			Note: Vinyl Tiles, Vinyl sheet Flooring, Drywall, Plaster and Textured Finish (Coat) are considered suspect materials if not sampled.

Units : SF - Square Feet LF - Linear Feet EA - Each % - Percentage

**Pinchin Environmental**  
**All Data**

**Project #: 13256**

**Client Name: St. Clair Catholic District School Board**

**Building #: 11**

**Building Name: St. Peter Canisius School Watford**

**Survey Date: 06/12/2010**

**Location #: 26**

**CORRIDOR**

**Floor: 1**

**Room Number:**

**Surveyor**

(cont'd)

System	Layer	System Component		Component Material		Component Item	Component Covering	Access	Visible	Condition						Units	Sample Number	Hazard
		Description	Code	Description	Code					Good	Action	Fair	Action	Poor	Action			
Structure	1	Not Applicable	N/A	Fibreglass	028	Not Applicable	Not Applicable	C	No	0	(-)	0	(-)	0	(-)	NI	V 0000	None
Walls	1	Not Applicable	N/A	Masonry	019	Not Applicable	Not Applicable	A	Yes	0	(-)	0	(-)	0	(-)	SF	V 0000	None
Walls	1	Not Applicable	N/A	Drywall	014	Not Applicable	Not Applicable	C	Yes	100	(-)	NE	(-)	NE	(-)	%	V 0000	None

Surveyor Notes: 031 - FTG - FOIL TAPE PRESENT OVER 044.

**Location #: 27**

**CORRIDOR**

**Floor: 1**

**Room Number:**

**Surveyor**

System	Layer	System Component		Component Material		Component Item	Component Covering	Access	Visible	Condition						Units	Sample Number	Hazard
		Description	Code	Description	Code					Good	Action	Fair	Action	Poor	Action			
Ceiling	1	Patterned pinholes	AT-005	Lay-in tiles	006	Not Applicable	Not Applicable	C	Yes	720	(-)	0	(-)	0	(-)	SF	V 0007	None
Duct	1	Not Applicable	N/A	Not Insulated	099	Not Applicable	Not Applicable	C	No	0	(-)	0	(-)	0	(-)	NI	V 0000	None
Floor	1	Not Applicable	N/A	Terrazzo	052	Not Applicable	Not Applicable	A	Yes	0	(-)	0	(-)	0	(-)	SF	V 0000	None
Mechanical	1	Not Found	N/F	Not Applicable	N/A	Not Applicable	Not Applicable	NI	No	0	(-)	0	(-)	0	(-)	NI	V 0000	None
Piping	1	Unidentified Pipe	UP	Fibreglass	028	Straight	Cheesecloth	C	No	0	(-)	0	(-)	0	(-)	NI	V 0000	None
Piping	1	Unidentified Pipe	UP	Parging Cement	031	Fitting	Cheesecloth	C	No	30	(7)	0	(-)	0	(-)	EA	V 0001	Asbestos
Structure	1	Not Applicable	N/A	Wood	004	Not Applicable	Not Applicable	C	No	0	(-)	0	(-)	0	(-)	NI	V 0000	None

**Legend:**

Access	Condition	Action	Sample Number
A - Accessible To All Building Occupants.	Good - No Visible damage or exposed material.	(-) No Action Required.	S #### Sample Collected.
B - Accessible To Maintenance Staff	Fair - Repairable Damage with minor amounts of exposed material.	(1) Immediate clean-up of debris or damaged ACM likely to be disturbed	V #### Material is visually identified to be identical to S ####.
	Poor - Irreparable damage with exposed & missing material.	(2) Type 2 precautions for entry into areas with ACM debris	V 0000 Material is visually identified to contain no asbestos.
C - Accessible To Maintenance Staff With a Ladder.	Note: Sprayed Materials are only rated as Good or Poor.	(3) ACM removal required	V 9000 Material is visually identified to contain asbestos.
D - Not Accessible.		(4) Type 2 precautions for entry into areas where ACM is present	V 9500 Material is suspected to contain asbestos.
			Note: Vinyl Tiles, Vinyl sheet Flooring, Drywall, Plaster and Textured Finish (Coat) are considered suspect materials if not sampled.

Units : SF - Square Feet LF - Linear Feet EA - Each % - Percentage

**Pinchin Environmental**  
**All Data**

**Project #:** 13256

**Client Name:** St. Clair Catholic District School Board

**Building #:** 11

**Building Name:** St. Peter Canisius School Watford

**Survey Date:** 06/12/2010

**Location #:** 27

**CORRIDOR**

**Floor:** 1

**Room Number:**

**Surveyor**

(cont'd)

System	Layer	System Component		Component Material		Component Item	Component Covering	Access	Visible	Condition						Units	Sample Number	Hazard
		Description	Code	Description	Code					Good	Action	Fair	Action	Poor	Action			
Structure	1	Not Applicable	N/A	Fibreglass	028	Not Applicable	Not Applicable	C	No	0	(-)	0	(-)	0	(-)	NI	V 0000	None
Walls	1	Not Applicable	N/A	Drywall	014	Not Applicable	Not Applicable	A	Yes	100	(7)	0	(-)	0	(-)	%	V 9000	Asbestos
Walls	1	Not Applicable	N/A	Masonry	019	Not Applicable	Not Applicable	A	Yes	0	(-)	0	(-)	0	(-)	SF	V 0000	None

Surveyor Notes: 031 - FTG - FOIL TAPE PRESENT OVER 044.  
LIMITED VIEW ABOVE CEILING.

**Location #:** 28

**CORRIDOR**

**Floor:** 1

**Room Number:**

**Surveyor**

System	Layer	System Component		Component Material		Component Item	Component Covering	Access	Visible	Condition						Units	Sample Number	Hazard
		Description	Code	Description	Code					Good	Action	Fair	Action	Poor	Action			
Ceiling	1	Not Applicable	N/A	Drywall	014	Base	Texture Coat	D	No	550	(7)	0	(-)	0	(-)	SF	V 9000	Asbestos
Ceiling	1	Not Applicable	N/A	Texture Coat	023	Surface	Not Applicable	A	Yes	0	(-)	0	(-)	0	(-)	SF	V 0000	None
Duct	1	Not Found	N/F	Not Applicable	N/A	Not Applicable	Not Applicable	NI	No	0	(-)	0	(-)	0	(-)	NI	V 0000	None
Floor	1	Not Applicable	N/A	Terrazzo	052	Not Applicable	Not Applicable	A	Yes	0	(-)	0	(-)	0	(-)	SF	V 0000	None
Mechanical	1	Not Found	N/F	Not Applicable	N/A	Not Applicable	Not Applicable	NI	No	0	(-)	0	(-)	0	(-)	NI	V 0000	None
Piping	1	Unidentified Pipe	UP	Not Insulated	099	Straight	Not Applicable	C	No	0	(-)	0	(-)	0	(-)	NI	V 0000	None
Structure	1	Beam, Deck, Joist	BDJ	Wood	004	Not Applicable	Not Applicable	C	No	0	(-)	0	(-)	0	(-)	NI	V 0000	None

**Legend:**

Access	Condition	Action	Sample Number
A - Accessible To All Building Occupants.	Good - No Visible damage or exposed material.	(-) No Action Required.	S #### Sample Collected.
B - Accessible To Maintenance Staff	Fair - Repairable Damage with minor amounts of exposed material.	(1) Immediate clean-up of debris or damaged ACM likely to be disturbed	V #### Material is visually identified to be identical to S ####.
	Poor - Irreparable damage with exposed & missing material.	(2) Type 2 precautions for entry into areas with ACM debris	V 0000 Material is visually identified to contain no asbestos.
C - Accessible To Maintenance Staff With a Ladder.	Note: Sprayed Materials are only rated as Good or Poor.	(3) ACM removal required	V 9000 Material is visually identified to contain asbestos.
D - Not Accessible.		(4) Type 2 precautions for entry into areas where ACM is present	V 9500 Material is suspected to contain asbestos.
			Note: Vinyl Tiles, Vinyl sheet Flooring, Drywall, Plaster and Textured Finish (Coat) are considered suspect materials if not sampled.

Units : SF - Square Feet LF - Linear Feet EA - Each % - Percentage

**Pinchin Environmental**  
**All Data**

**Project #:** 13256

**Client Name:** St. Clair Catholic District School Board

**Building #:** 11

**Building Name:** St. Peter Canisius School Watford

**Survey Date:** 06/12/2010

**Location #:** 28

**CORRIDOR**

**Floor:** 1

**Room Number:**

**Surveyor**

(cont'd)

System	Layer	System Component		Component Material		Component Item	Component Covering	Access	Visible	Condition						Units	Sample Number	Hazard
		Description	Code	Description	Code					Good	Action	Fair	Action	Poor	Action			
Walls	1	Not Applicable	N/A	Masonry	019	Not Applicable	Not Applicable	A	Yes	0	(-)	0	(-)	0	(-)	SF	V 0000	None
Piping	1	Unidentified Pipe	UP	Not Insulated	099	Fitting		C	No	0	(-)	0	(-)	0	(-)	NI	V 0000	None

Surveyor Notes: SMALL CEILING ACCESS.

**Location #:** 29

**CUSTODIAN ROOM**

**Floor:** 1

**Room Number:**

**Surveyor**

System	Layer	System Component		Component Material		Component Item	Component Covering	Access	Visible	Condition						Units	Sample Number	Hazard
		Description	Code	Description	Code					Good	Action	Fair	Action	Poor	Action			
Ceiling	1	Width fissures with	AT-006	Lay-in tiles	006	Not Applicable	Not Applicable	C	Yes	200	(-)	0	(-)	0	(-)	SF	S 0008	None
Duct	1	Not Found	N/F	Not Applicable	N/A	Not Applicable	Not Applicable	NI	No	0	(-)	0	(-)	0	(-)	NI	V 0000	None
Floor	1	Not Applicable	N/A	Vinyl tiles	008	Not Applicable	Not Applicable	A	Yes	200	(-)	0	(-)	0	(-)	SF	V 0000	None
Mechanical	1	Not Found	N/F	Not Applicable	N/A	Not Applicable	Not Applicable	NI	No	0	(-)	0	(-)	0	(-)	NI	V 0000	None
Piping	1	Not Found	N/F	Not Applicable	N/A	Not Applicable	Not Applicable	NI	No	0	(-)	0	(-)	0	(-)	NI	V 0000	None
Structure	1	Not Found	N/F	Not Applicable	N/A	Not Applicable	Not Applicable	NI	No	0	(-)	0	(-)	0	(-)	NI	V 0000	None
Walls	1	Not Applicable	N/A	Masonry	019	Not Applicable	Not Applicable	A	Yes	0	(-)	0	(-)	0	(-)	SF	V 0000	None

**Legend:**

Access	Condition	Action	Sample Number
A - Accessible To All Building Occupants.	Good - No Visible damage or exposed material.	(-) No Action Required.	S #### Sample Collected.
B - Accessible To Maintenance Staff	Fair - Repairable Damage with minor amounts of exposed material.	(1) Immediate clean-up of debris or damaged ACM likely to be disturbed	V #### Material is visually identified to be identical to S ####.
	Poor - Irreparable damage with exposed & missing material.	(2) Type 2 precautions for entry into areas with ACM debris	V 0000 Material is visually identified to contain no asbestos.
C - Accessible To Maintenance Staff With a Ladder.	Note: Sprayed Materials are only rated as Good or Poor.	(3) ACM removal required	V 9000 Material is visually identified to contain asbestos.
D - Not Accessible.		(4) Type 2 precautions for entry into areas where ACM is present	V 9500 Material is suspected to contain asbestos.
			Note: Vinyl Tiles, Vinyl sheet Flooring, Drywall, Plaster and Textured Finish (Coat) are considered suspect materials if not sampled.

Units : SF - Square Feet LF - Linear Feet EA - Each % - Percentage



**Pinchin Environmental**  
**All Data**

**Project #:** 13256

**Client Name:** St. Clair Catholic District School Board

**Building #:** 11

**Building Name:** St. Peter Canisius School Watford

**Survey Date:** 06/12/2010

Surveyor Notes:

**Location #:** 30

**CLASSROOM**

**Floor:** 1

**Room Number:** 201 A

**Surveyor**

System	Layer	System Component		Component Material		Component Item	Component Covering	Access	Visible	Condition						Units	Sample Number	Hazard
		Description	Code	Description	Code					Good	Action	Fair	Action	Poor	Action			
Ceiling	1	Not Applicable	N/A	Drywall	014	Not Applicable	Not Applicable	C	No	600	(7)	0	(-)	0	(-)	SF	V 9000	Asbestos
Ceiling	1	Fissures and pinholes	AT-007	Lay-in tiles	006	Not Applicable	Not Applicable	C	Yes	600	(-)	0	(-)	0	(-)	SF	S 0009	None
Duct	1	Not Found	N/F	Not Applicable	N/A	Not Applicable	Not Applicable	NI	No	0	(-)	0	(-)	0	(-)	NI	V 0000	None
Floor	1	Not Applicable	N/A	Carpet	050	Not Applicable	Not Applicable	A	Yes	0	(-)	0	(-)	0	(-)	SF	V 0000	None
Mechanical	1	Not Found	N/F	Not Applicable	N/A	Not Applicable	Not Applicable	NI	No	0	(-)	0	(-)	0	(-)	NI	V 0000	None
Piping	1	Not Found	N/F	Not Applicable	N/A	Not Applicable	Not Applicable	NI	No	0	(-)	0	(-)	0	(-)	NI	V 0000	None
Structure	1	Not Found	N/F	Not Applicable	N/A	Not Applicable	Not Applicable	NI	No	0	(-)	0	(-)	0	(-)	NI	V 0000	None
Walls	1	Not Applicable	N/A	Drywall	014	Not Applicable	Not Applicable	A	Yes	100	(7)	0	(-)	0	(-)	%	V 9000	Asbestos

Surveyor Notes: MERCURY THERMOSTAT IS PRESENT AT THIS LOCATION.

**Legend:**

Access	Condition	Action	Sample Number
A - Accessible To All Building Occupants.	Good - No Visible damage or exposed material.	(-) No Action Required.	S #### Sample Collected.
B - Accessible To Maintenance Staff	Fair - Repairable Damage with minor amounts of exposed material.	(1) Immediate clean-up of debris or damaged ACM likely to be disturbed	V #### Material is visually identified to be identical to S ####.
C - Accessible To Maintenance Staff With a Ladder.	Poor - Irreparable damage with exposed & missing material.	(2) Type 2 precautions for entry into areas with ACM debris	V 0000 Material is visually identified to contain no asbestos.
D - Not Accessible.	Note: Sprayed Materials are only rated as Good or Poor.	(3) ACM removal required	V 9000 Material is visually identified to contain asbestos.
		(4) Type 2 precautions for entry into areas where ACM is present	V 9500 Material is suspected to contain asbestos.
		(5) Proactive ACM removal	Note: Vinyl Tiles, Vinyl sheet Flooring, Drywall, Plaster and Textured Finish (Coat) are considered suspect materials if not sampled.
		(6) Proactive ACM repair	
		(7) Management program and surveillance	
		(8) Suspect Material	

Units : SF - Square Feet LF - Linear Feet EA - Each % - Percentage

**Pinchin Environmental**  
**All Data**

**Project #:** 13256

**Client Name:** St. Clair Catholic District School Board

**Building #:** 11

**Building Name:** St. Peter Canisius School Watford

**Survey Date:** 06/12/2010

**Location #:** 31

**CLASSROOM**

**Floor:** 1

**Room Number:** 202 A

**Surveyor**

System	Layer	System Component		Component Material		Component Item	Component Covering	Access	Visible	Condition						Units	Sample Number	Hazard
		Description	Code	Description	Code					Good	Action	Fair	Action	Poor	Action			
Ceiling	1	Not Applicable	N/A	Drywall	014	Not Applicable	Not Applicable	C	No	600	(7)	0	(-)	0	(-)	SF	V 9000	Asbestos
Ceiling	1	Fissures and pinholes	AT-007	Lay-in tiles	006	Not Applicable	Not Applicable	C	Yes	600	(-)	0	(-)	0	(-)	SF	V 0009	None
Duct	1	Not Found	N/F	Not Applicable	N/A	Not Applicable	Not Applicable	NI	No	0	(-)	0	(-)	0	(-)	NI	V 0000	None
Floor	1	Not Applicable	N/A	Carpet	050	Not Applicable	Not Applicable	A	Yes	0	(-)	0	(-)	0	(-)	SF	V 0000	None
Mechanical	1	Not Found	N/F	Not Applicable	N/A	Not Applicable	Not Applicable	NI	No	0	(-)	0	(-)	0	(-)	NI	V 0000	None
Piping	1	Not Found	N/F	Not Applicable	N/A	Not Applicable	Not Applicable	NI	No	0	(-)	0	(-)	0	(-)	NI	V 0000	None
Structure	1	Not Found	N/F	Not Applicable	N/A	Not Applicable	Not Applicable	NI	No	0	(-)	0	(-)	0	(-)	NI	V 0000	None
Walls	1	Not Applicable	N/A	Drywall	014	Not Applicable	Not Applicable	A	Yes	100	(7)	0	(-)	0	(-)	%	V 9000	Asbestos

Surveyor Notes: MERCURY THERMOSTAT IS PRESENT AT THIS LOCATION.

**Location #:** 32

**CLASSROOM**

**Floor:** 1

**Room Number:** 303 A

**Surveyor**

System	Layer	System Component		Component Material		Component Item	Component Covering	Access	Visible	Condition						Units	Sample Number	Hazard
		Description	Code	Description	Code					Good	Action	Fair	Action	Poor	Action			
Ceiling	1	Not Accessible	NAC	Drywall	014	Not Applicable	Not Applicable	C	No	600	(7)	0	(-)	0	(-)	SF	V 9000	Asbestos
Ceiling	1	Fissures and pinholes	AT-007	Lay-in tiles	006	Not Applicable	Not Applicable	C	Yes	600	(-)	0	(-)	0	(-)	SF	V 0009	None

**Legend:**

Access	Condition	Action	Sample Number
A - Accessible To All Building Occupants.	Good - No Visible damage or exposed material.	(-) No Action Required.	S #### Sample Collected.
B - Accessible To Maintenance Staff	Fair - Repairable Damage with minor amounts of exposed material.	(1) Immediate clean-up of debris or damaged ACM likely to be disturbed	V #### Material is visually identified to be identical to S ####.
C - Accessible To Maintenance Staff With a Ladder.	Poor - Irreparable damage with exposed & missing material.	(2) Type 2 precautions for entry into areas with ACM debris	V 0000 Material is visually identified to contain no asbestos.
D - Not Accessible.	Note: Sprayed Materials are only rated as Good or Poor.	(3) ACM removal required	V 9000 Material is visually identified to contain asbestos.
		(4) Type 2 precautions for entry into areas where ACM is present	V 9500 Material is suspected to contain asbestos.
		(5) Proactive ACM removal	Note: Vinyl Tiles, Vinyl sheet Flooring, Drywall, Plaster and Textured Finish (Coat) are considered suspect materials if not sampled.
		(6) Proactive ACM repair	
		(7) Management program and surveillance	
		(8) Suspect Material	

Units : SF - Square Feet LF - Linear Feet EA - Each % - Percentage

**Pinchin Environmental**  
**All Data**

**Project #:** 13256

**Client Name:** St. Clair Catholic District School Board

**Building #:** 11

**Building Name:** St. Peter Canisius School Watford

**Survey Date:** 06/12/2010

**Location #:** 32

**CLASSROOM**

**Floor:** 1

**Room Number:** 303 A

**Surveyor**

(cont'd)

System	Layer	System Component		Component Material		Component Item	Component Covering	Access	Visible	Condition						Units	Sample Number	Hazard
		Description	Code	Description	Code					Good	Action	Fair	Action	Poor	Action			
Duct	1	Not Found	N/F	Not Applicable	N/A	Not Applicable	Not Applicable	NI	No	0	(-)	0	(-)	0	(-)	NI	V 0000	None
Floor	1	Not Applicable	N/A	Carpet	050	Not Applicable	Not Applicable	A	Yes	0	(-)	0	(-)	0	(-)	SF	V 0000	None
Mechanical	1	Not Found	N/F	Not Applicable	N/A	Not Applicable	Not Applicable	NI	No	0	(-)	0	(-)	0	(-)	NI	V 0000	None
Piping	1	Not Found	N/F	Not Applicable	N/A	Not Applicable	Not Applicable	NI	No	0	(-)	0	(-)	0	(-)	NI	V 0000	None
Structure	1	Not Found	N/F	Not Applicable	N/A	Not Applicable	Not Applicable	NI	No	0	(-)	0	(-)	0	(-)	NI	V 0000	None
Walls	1	Not Applicable	N/A	Drywall	014	Not Applicable	Not Applicable	A	Yes	100	(7)	0	(-)	0	(-)	%	V 9000	Asbestos

Surveyor Notes: MERCURY THERMOSTAT IS PRESENT AT THIS LOCATION.

**Location #:** 33

**CLASSROOM**

**Floor:** 1

**Room Number:** 109 A

**Surveyor**

System	Layer	System Component		Component Material		Component Item	Component Covering	Access	Visible	Condition						Units	Sample Number	Hazard
		Description	Code	Description	Code					Good	Action	Fair	Action	Poor	Action			
Ceiling	1	Not Accessible	NAC	Drywall	014	Not Applicable	Not Applicable	C	No	600	(7)	0	(-)	0	(-)	SF	V 9000	Asbestos
Ceiling	1	Fissures and pinholes	AT-007	Lay-in tiles	006	Not Applicable	Not Applicable	C	Yes	600	(-)	0	(-)	0	(-)	SF	V 0009	None
Duct	1	Not Found	N/F	Not Applicable	N/A	Not Applicable	Not Applicable	NI	No	0	(-)	0	(-)	0	(-)	NI	V 0000	None
Floor	1	Not Applicable	N/A	Carpet	050	Not Applicable	Not Applicable	A	Yes	0	(-)	0	(-)	0	(-)	SF	V 0000	None

**Legend:**

Access	Condition	Action	Sample Number
A - Accessible To All Building Occupants.	Good - No Visible damage or exposed material.	(-) No Action Required.	S #### Sample Collected.
B - Accessible To Maintenance Staff	Fair - Repairable Damage with minor amounts of exposed material.	(1) Immediate clean-up of debris or damaged ACM likely to be disturbed	V #### Material is visually identified to be identical to S ####.
	Poor - Irreparable damage with exposed & missing material.	(2) Type 2 precautions for entry into areas with ACM debris	V 0000 Material is visually identified to contain no asbestos.
C - Accessible To Maintenance Staff With a Ladder.	Note: Sprayed Materials are only rated as Good or Poor.	(3) ACM removal required	V 9000 Material is visually identified to contain asbestos.
D - Not Accessible.		(4) Type 2 precautions for entry into areas where ACM is present	V 9500 Material is suspected to contain asbestos.
			Note: Vinyl Tiles, Vinyl sheet Flooring, Drywall, Plaster and Textured Finish (Coat) are considered suspect materials if not sampled.

Units : SF - Square Feet LF - Linear Feet EA - Each % - Percentage

**Pinchin Environmental**  
**All Data**

**Project #:** 13256

**Client Name:** St. Clair Catholic District School Board

**Building #:** 11

**Building Name:** St. Peter Canisius School Watford

**Survey Date:** 06/12/2010

**Location #:** 33

**CLASSROOM**

**Floor:** 1

**Room Number:** 109 A

**Surveyor**

(cont'd)

System	Layer	System Component		Component Material		Component Item	Component Covering	Access	Visible	Condition						Units	Sample Number	Hazard
		Description	Code	Description	Code					Good	Action	Fair	Action	Poor	Action			
Mechanical	1	Not Found	N/F	Not Applicable	N/A	Not Applicable	Not Applicable	NI	No	0	(-)	0	(-)	0	(-)	NI	V 0000	None
Piping	1	Not Found	N/F	Not Applicable	N/A	Not Applicable	Not Applicable	NI	No	0	(-)	0	(-)	0	(-)	NI	V 0000	None
Structure	1	Not Found	N/F	Not Applicable	N/A	Not Applicable	Not Applicable	NI	No	0	(-)	0	(-)	0	(-)	NI	V 0000	None
Walls	1	Not Applicable	N/A	Drywall	014	Not Applicable	Not Applicable	A	Yes	100	(7)	0	(-)	0	(-)	%	V 9000	Asbestos

Surveyor Notes: MERCURY THERMOSTAT IS PRESENT AT THIS LOCATION.

**Location #:** 34

**CLASSROOM**

**Floor:** 1

**Room Number:** 102 A

**Surveyor**

System	Layer	System Component		Component Material		Component Item	Component Covering	Access	Visible	Condition						Units	Sample Number	Hazard
		Description	Code	Description	Code					Good	Action	Fair	Action	Poor	Action			
Ceiling	1	Not Accessible	NAC	Drywall	014	Not Applicable	Not Applicable	C	No	600	(7)	0	(-)	0	(-)	SF	V 9000	Asbestos
Ceiling	1	Fissures and pinholes	AT-007	Lay-in tiles	006	Not Applicable	Not Applicable	C	Yes	600	(-)	0	(-)	0	(-)	SF	V 0009	None
Duct	1	Not Found	N/F	Not Applicable	N/A	Not Applicable	Not Applicable	NI	No	0	(-)	0	(-)	0	(-)	NI	V 0000	None
Floor	1	Not Applicable	N/A	Carpet	050	Not Applicable	Not Applicable	A	Yes	0	(-)	0	(-)	0	(-)	SF	V 0000	None
Mechanical	1	Not Found	N/F	Not Applicable	N/A	Not Applicable	Not Applicable	NI	No	0	(-)	0	(-)	0	(-)	NI	V 0000	None
Piping	1	Not Found	N/F	Not Applicable	N/A	Not Applicable	Not Applicable	NI	No	0	(-)	0	(-)	0	(-)	NI	V 0000	None

**Legend:**

Access	Condition	Action	Sample Number
A - Accessible To All Building Occupants.	Good - No Visible damage or exposed material.	(-) No Action Required.	S #### Sample Collected.
B - Accessible To Maintenance Staff	Fair - Repairable Damage with minor amounts of exposed material.	(1) Immediate clean-up of debris or damaged ACM likely to be disturbed	V #### Material is visually identified to be identical to S ####.
	Poor - Irreparable damage with exposed & missing material.	(2) Type 2 precautions for entry into areas with ACM debris	V 0000 Material is visually identified to contain no asbestos.
C - Accessible To Maintenance Staff With a Ladder.	Note: Sprayed Materials are only rated as Good or Poor.	(3) ACM removal required	V 9000 Material is visually identified to contain asbestos.
D - Not Accessible.		(4) Type 2 precautions for entry into areas where ACM is present	V 9500 Material is suspected to contain asbestos.
			Note: Vinyl Tiles, Vinyl sheet Flooring, Drywall, Plaster and Textured Finish (Coat) are considered suspect materials if not sampled.

Units : SF - Square Feet LF - Linear Feet EA - Each % - Percentage

**Pinchin Environmental**  
**All Data**

**Project #: 13256**

**Client Name: St. Clair Catholic District School Board**

**Building #: 11**

**Building Name: St. Peter Canisius School Watford**

**Survey Date: 06/12/2010**

**Location #: 34**

**CLASSROOM**

**Floor: 1**

**Room Number: 102 A**

**Surveyor**

(cont'd)

System	Layer	System Component		Component Material		Component Item	Component Covering	Access	Visible	Condition						Units	Sample Number	Hazard
		Description	Code	Description	Code					Good	Action	Fair	Action	Poor	Action			
Structure	1	Not Found	N/F	Not Applicable	N/A	Not Applicable	Not Applicable	NI	No	0	(-)	0	(-)	0	(-)	NI	V 0000	None
Walls	1	Not Applicable	N/A	Drywall	014	Not Applicable	Not Applicable	A	Yes	100	(7)	0	(-)	0	(-)	%	V 9000	Asbestos

Surveyor Notes: MERCURY THERMOSTAT IS PRESENT AT THIS LOCATION.

**Location #: 35**

**CLASSROOM**

**Floor: 1**

**Room Number: 205 A**

**Surveyor**

System	Layer	System Component		Component Material		Component Item	Component Covering	Access	Visible	Condition						Units	Sample Number	Hazard
		Description	Code	Description	Code					Good	Action	Fair	Action	Poor	Action			
Ceiling	1	Not Accessible	NAC	Drywall	014	Not Applicable	Not Applicable	C	No	280	(7)	0	(-)	0	(-)	SF	V 9000	Asbestos
Ceiling	1	Fissures and pinholes	AT-007	Lay-in tiles	006	Not Applicable	Not Applicable	C	Yes	280	(-)	0	(-)	0	(-)	SF	V 0009	None
Duct	1	Not Found	N/F	Not Applicable	N/A	Not Applicable	Not Applicable	NI	No	0	(-)	0	(-)	0	(-)	NI	V 0000	None
Floor	1	Not Applicable	N/A	Carpet	050	Not Applicable	Not Applicable	A	Yes	0	(-)	0	(-)	0	(-)	SF	V 0000	None
Mechanical	1	Not Found	N/F	Not Applicable	N/A	Not Applicable	Not Applicable	NI	No	0	(-)	0	(-)	0	(-)	NI	V 0000	None
Piping	1	Not Found	N/F	Not Applicable	N/A	Not Applicable	Not Applicable	NI	No	0	(-)	0	(-)	0	(-)	NI	V 0000	None
Structure	1	Not Found	N/F	Not Applicable	N/A	Not Applicable	Not Applicable	NI	No	0	(-)	0	(-)	0	(-)	NI	V 0000	None
Walls	1	Not Applicable	N/A	Drywall	014	Not Applicable	Not Applicable	A	Yes	100	(7)	0	(-)	0	(-)	%	V 9000	Asbestos

**Legend:**

Access	Condition	Action	Sample Number
A - Accessible To All Building Occupants.	Good - No Visible damage or exposed material.	(-) No Action Required.	S #### Sample Collected.
B - Accessible To Maintenance Staff	Fair - Repairable Damage with minor amounts of exposed material.	(1) Immediate clean-up of debris or damaged ACM likely to be disturbed	V #### Material is visually identified to be identical to S ####.
	Poor - Irreparable damage with exposed & missing material.	(2) Type 2 precautions for entry into areas with ACM debris	V 0000 Material is visually identified to contain no asbestos.
C - Accessible To Maintenance Staff With a Ladder.	Note: Sprayed Materials are only rated as Good or Poor.	(3) ACM removal required	V 9000 Material is visually identified to contain asbestos.
D - Not Accessible.		(4) Type 2 precautions for entry into areas where ACM is present	V 9500 Material is suspected to contain asbestos.
			Note: Vinyl Tiles, Vinyl sheet Flooring, Drywall, Plaster and Textured Finish (Coat) are considered suspect materials if not sampled.

Units : SF - Square Feet LF - Linear Feet EA - Each % - Percentage

**Pinchin Environmental**  
**All Data**

**Project #:** 13256

**Client Name:** St. Clair Catholic District School Board

**Building #:** 11

**Building Name:** St. Peter Canisius School Watford

**Survey Date:** 06/12/2010

Surveyor Notes: MERCURY THERMOSTAT IS PRESENT AT THIS LOCATION.

**Location #:** 36

**GIRL'S WASHROOM**

**Floor:** 1

**Room Number:** 206 P

**Surveyor**

System	Layer	System Component		Component Material		Component Item	Component Covering	Access	Visible	Condition						Units	Sample Number	Hazard
		Description	Code	Description	Code					Good	Action	Fair	Action	Poor	Action			
Ceiling	1	Not Accessible	NAC	Drywall	014	Not Applicable	Not Applicable	C	No	200	(7)	0	(-)	0	(-)	SF	V 9000	Asbestos
Ceiling	1	Fissures and pinholes	AT-007	Lay-in tiles	006	Not Applicable	Not Applicable	C	Yes	200	(-)	0	(-)	0	(-)	SF	V 0009	None
Duct	1	Not Found	N/F	Not Applicable	N/A	Not Applicable	Not Applicable	NI	No	0	(-)	0	(-)	0	(-)	NI	V 0000	None
Floor	1	Not Applicable	N/A	Vinyl sheet	009	Not Applicable	Not Applicable	A	Yes	200	(-)	0	(-)	0	(-)	SF	S 0010	None
Mechanical	1	Not Found	N/F	Not Applicable	N/A	Not Applicable	Not Applicable	NI	No	0	(-)	0	(-)	0	(-)	NI	V 0000	None
Piping	1	Unidentified Pipe	UP	Not Insulated	099	Straight	Not Applicable	C	No	0	(-)	0	(-)	0	(-)	NI	V 0000	None
Structure	1	Not Found	N/F	Not Applicable	N/A	Not Applicable	Not Applicable	NI	No	0	(-)	0	(-)	0	(-)	NI	V 0000	None
Walls	1	Not Applicable	N/A	Drywall	014	Not Applicable	Not Applicable	A	Yes	100	(7)	0	(-)	0	(-)	%	V 9000	Asbestos
Piping	1	Unidentified Pipe	UP	Not Insulated	099	Fitting	Not Applicable	C	No	0	(-)	0	(-)	0	(-)	NI	V 0000	None

Surveyor Notes:

**Legend:**

Access	Condition	Action	Sample Number
A - Accessible To All Building Occupants.	Good - No Visible damage or exposed material.	(-) No Action Required.	S #### Sample Collected.
B - Accessible To Maintenance Staff	Fair - Repairable Damage with minor amounts of exposed material.	(1) Immediate clean-up of debris or damaged ACM likely to be disturbed	V #### Material is visually identified to be identical to S ####.
	Poor - Irreparable damage with exposed & missing material.	(2) Type 2 precautions for entry into areas with ACM debris	V 0000 Material is visually identified to contain no asbestos.
C - Accessible To Maintenance Staff With a Ladder.	Note: Sprayed Materials are only rated as Good or Poor.	(3) ACM removal required	V 9000 Material is visually identified to contain asbestos.
D - Not Accessible.		(4) Type 2 precautions for entry into areas where ACM is present	V 9500 Material is suspected to contain asbestos.
		(5) Proactive ACM removal	Note: Vinyl Tiles, Vinyl sheet Flooring, Drywall, Plaster and Textured Finish (Coat) are considered suspect materials if not sampled.
		(6) Proactive ACM repair	
		(7) Management program and surveillance	
		(8) Suspect Material	

Units : SF - Square Feet LF - Linear Feet EA - Each % - Percentage

**Pinchin Environmental**  
**All Data**

**Project #:** 13256

**Client Name:** St. Clair Catholic District School Board

**Building #:** 11

**Building Name:** St. Peter Canisius School Watford

**Survey Date:** 06/12/2010

**Location #:** 37

**BOY'S WASHROOM**

**Floor:** 1

**Room Number:** 207 P

**Surveyor**

System	Layer	System Component		Component Material		Component Item	Component Covering	Access	Visible	Condition						Units	Sample Number	Hazard
		Description	Code	Description	Code					Good	Action	Fair	Action	Poor	Action			
Ceiling	1	Not Accessible	NAC	Drywall	014	Not Applicable	Not Applicable	C	No	200	(7)	0	(-)	0	(-)	SF	V 9000	Asbestos
Ceiling	1	Fissures and pinholes	AT-007	Lay-in tiles	006	Not Applicable	Not Applicable	C	Yes	200	(-)	0	(-)	0	(-)	SF	V 0009	None
Duct	1	Not Found	N/F	Not Applicable	N/A	Not Applicable	Not Applicable	NI	No	0	(-)	0	(-)	0	(-)	NI	V 0000	None
Floor	1	Not Applicable	N/A	Vinyl sheet	009	Not Applicable	Not Applicable	A	Yes	200	(-)	0	(-)	0	(-)	SF	S 0011	None
Mechanical	1	Not Found	N/F	Not Applicable	N/A	Not Applicable	Not Applicable	NI	No	0	(-)	0	(-)	0	(-)	NI	V 0000	None
Piping	1	Domestic Water (Hot &	DW	Not Insulated	099	Straight	Not Applicable	A	Yes	0	(-)	0	(-)	0	(-)	NI	V 0000	None
Structure	1	Not Found	N/F	Not Applicable	N/A	Not Applicable	Not Applicable	NI	No	0	(-)	0	(-)	0	(-)	NI	V 0000	None
Walls	1	Not Applicable	N/A	Drywall	014	Not Applicable	Not Applicable	A	Yes	100	(7)	0	(-)	0	(-)	%	V 9000	Asbestos
Piping	1	Domestic Water (Hot &	DW	Not Insulated	099	Fitting	Not Applicable	A	Yes	0	(-)	0	(-)	0	(-)	NI	V 0000	None

Surveyor Notes:

**Legend:**

Access	Condition	Action	Sample Number
A - Accessible To All Building Occupants.	Good - No Visible damage or exposed material.	(-) No Action Required.	S #### Sample Collected.
B - Accessible To Maintenance Staff	Fair - Repairable Damage with minor amounts of exposed material.	(1) Immediate clean-up of debris or damaged ACM likely to be disturbed	V #### Material is visually identified to be identical to S ####.
C - Accessible To Maintenance Staff With a Ladder.	Poor - Irreparable damage with exposed & missing material.	(2) Type 2 precautions for entry into areas with ACM debris	V 0000 Material is visually identified to contain no asbestos.
D - Not Accessible.	Note: Sprayed Materials are only rated as Good or Poor.	(3) ACM removal required	V 9000 Material is visually identified to contain asbestos.
		(4) Type 2 precautions for entry into areas where ACM is present	V 9500 Material is suspected to contain asbestos.
		(5) Proactive ACM removal	Note: Vinyl Tiles, Vinyl sheet Flooring, Drywall, Plaster and Textured Finish (Coat) are considered suspect materials if not sampled.
		(6) Proactive ACM repair	
		(7) Management program and surveillance	
		(8) Suspect Material	

Units : SF - Square Feet LF - Linear Feet EA - Each % - Percentage

**Pinchin Environmental**  
**All Data**

**Project #: 13256**

**Client Name: St. Clair Catholic District School Board**

**Building #: 11**

**Building Name: St. Peter Canisius School Watford**

**Survey Date: 06/12/2010**

**Location #: 38**

**CORRIDOR**

**Floor: 1**

**Room Number:**

**Surveyor**

System	Layer	System Component		Component Material		Component Item	Component Covering	Access	Visible	Condition						Units	Sample Number	Hazard
		Description	Code	Description	Code					Good	Action	Fair	Action	Poor	Action			
Ceiling	1	Not Accessible	NAC	Drywall	014	Not Applicable	Not Applicable	C	No	800	(7)	0	(-)	0	(-)	SF	V 9000	Asbestos
Ceiling	1	Width fissures with	AT-006	Lay-in tiles	006	Not Applicable	Not Applicable	C	Yes	800	(-)	0	(-)	0	(-)	SF	V 0008	None
Duct	1	Not Found	N/F	Not Applicable	N/A	Not Applicable	Not Applicable	NI	No	0	(-)	0	(-)	0	(-)	NI	V 0000	None
Floor	1	Not Applicable	N/A	Vinyl tiles	008	Not Applicable	Not Applicable	A	Yes	800	(7)	0	(-)	0	(-)	SF	V 9000	Asbestos
Mechanical	1	Not Found	N/F	Not Applicable	N/A	Not Applicable	Not Applicable	NI	No	0	(-)	0	(-)	0	(-)	NI	V 0000	None
Piping	1	Not Found	N/F	Not Applicable	N/A	Not Applicable	Not Applicable	NI	No	0	(-)	0	(-)	0	(-)	NI	V 0000	None
Structure	1	Not Found	N/F	Not Applicable	N/A	Not Applicable	Not Applicable	NI	No	0	(-)	0	(-)	0	(-)	NI	V 0000	None
Walls	1	Not Applicable	N/A	Steel	001	Not Applicable	Not Applicable	A	Yes	0	(-)	0	(-)	0	(-)	SF	V 0000	None
Walls	1	Not Applicable	N/A	Drywall	014	Not Applicable	Not Applicable	A	Yes	100	(7)	0	(-)	0	(-)	%	V 9000	Asbestos

Surveyor Notes:

**Legend:**

Access	Condition	Action	Sample Number
A - Accessible To All Building Occupants.	Good - No Visible damage or exposed material.	(-) No Action Required.	S #### Sample Collected.
B - Accessible To Maintenance Staff	Fair - Repairable Damage with minor amounts of exposed material.	(1) Immediate clean-up of debris or damaged ACM likely to be disturbed	V #### Material is visually identified to be identical to S ####.
	Poor - Irreparable damage with exposed & missing material.	(2) Type 2 precautions for entry into areas with ACM debris	V 0000 Material is visually identified to contain no asbestos.
C - Accessible To Maintenance Staff With a Ladder.	Note: Sprayed Materials are only rated as Good or Poor.	(3) ACM removal required	V 9000 Material is visually identified to contain asbestos.
D - Not Accessible.		(4) Type 2 precautions for entry into areas where ACM is present	V 9500 Material is suspected to contain asbestos.
		(5) Proactive ACM removal	Note: Vinyl Tiles, Vinyl sheet Flooring, Drywall, Plaster and Textured Finish (Coat) are considered suspect materials if not sampled.
		(6) Proactive ACM repair	
		(7) Management program and surveillance	
		(8) Suspect Material	

Units : SF - Square Feet LF - Linear Feet EA - Each % - Percentage



**Pinchin Environmental**  
**All Data**

**Project #:** 13256

**Client Name:** St. Clair Catholic District School Board

**Building #:** 11

**Building Name:** St. Peter Canisius School Watford

**Survey Date:** 06/12/2010

**Location #:** 39

Office

**Floor:** 1

**Room Number:** 303 P

**Surveyor**

System	Layer	System Component		Component Material		Component Item	Component Covering	Access	Visible	Condition						Units	Sample Number	Hazard
		Description	Code	Description	Code					Good	Action	Fair	Action	Poor	Action			
Ceiling	1	Patterned pinholes	AT-005	Lay-in tiles	006	Not Applicable	Not Applicable	C	Yes	100	(-)	0	(-)	0	(-)	SF	V 0007	None
Ceiling	1	Fissures and pinholes	AT-007	Lay-in tiles	006	Not Applicable	Not Applicable	C	Yes	20	(-)	0	(-)	0	(-)	SF	V 0009	None
Duct	1	Not Found	N/F	Not Applicable	N/A	Not Applicable	Not Applicable	NI	No	0	(-)	0	(-)	0	(-)	NI	V 0000	None
Mechanical	1	Not Found	N/F	Not Applicable	N/A	Not Applicable	Not Applicable	NI	No	0	(-)	0	(-)	0	(-)	NI	V 0000	None
Piping	1	Not Found	N/F	Not Applicable	N/A	Not Applicable	Not Applicable	NI	No	0	(-)	0	(-)	0	(-)	NI	V 0000	None
Structure	1	Not Found	N/F	Not Applicable	N/A	Not Applicable	Not Applicable	NI	No	0	(-)	0	(-)	0	(-)	NI	V 0000	None
Walls	1	Not Applicable	N/A	Masonry	019	Not Applicable	Not Applicable	A	Yes	0000	(-)	0	(-)	0	(-)	%	V 0000	None

Surveyor Notes: All part of locatin 9

**Location #:** 40

Kindergarten Washroom

**Floor:** 1

**Room Number:**

**Surveyor**

System	Layer	System Component		Component Material		Component Item	Component Covering	Access	Visible	Condition						Units	Sample Number	Hazard
		Description	Code	Description	Code					Good	Action	Fair	Action	Poor	Action			
Floor	1		NI	Vinyl sheet	009			A	Yes	30	(-)	0	(-)	0	(-)	SF	V 0010	None
Walls	1		NI	Masonry	019			NI	No	0	(-)	0	(-)	0	(-)	NI	V 0000	None
Ceiling	1	Not Accessible	NAC	Drywall	014			A	Yes	30	(7)	0	(-)	0	(-)	SF	V 9000	Asbestos

**Legend:**

Access	Condition	Action	Sample Number
A - Accessible To All Building Occupants.	Good - No Visible damage or exposed material.	(-) No Action Required.	S #### Sample Collected.
B - Accessible To Maintenance Staff	Fair - Repairable Damage with minor amounts of exposed material.	(1) Immediate clean-up of debris or damaged ACM likely to be disturbed	V #### Material is visually identified to be identical to S ####.
C - Accessible To Maintenance Staff With a Ladder.	Poor - Irreparable damage with exposed & missing material.	(2) Type 2 precautions for entry into areas with ACM debris	V 0000 Material is visually identified to contain no asbestos.
D - Not Accessible.	Note: Sprayed Materials are only rated as Good or Poor.	(3) ACM removal required	V 9000 Material is visually identified to contain asbestos.
		(4) Type 2 precautions for entry into areas where ACM is present	V 9500 Material is suspected to contain asbestos.
		(5) Proactive ACM removal	Note: Vinyl Tiles, Vinyl sheet Flooring, Drywall, Plaster and Textured Finish (Coat) are considered suspect materials if not sampled.
		(6) Proactive ACM repair	
		(7) Management program and surveillance	
		(8) Suspect Material	

Units : SF - Square Feet LF - Linear Feet EA - Each % - Percentage

**Pinchin Environmental**  
**All Data**

**Project #:** 13256

**Client Name:** St. Clair Catholic District School Board

**Building #:** 11

**Building Name:** St. Peter Canisius School Watford

**Survey Date:** 06/12/2010

**Location #:** 40

Kindergarten Washroom

**Floor:** 1

**Room Number:**

**Surveyor**

(cont'd)

System	Layer	System Component		Component Material		Component Item	Component Covering	Access	Visible	Condition						Units	Sample Number	Hazard
		Description	Code	Description	Code					Good	Action	Fair	Action	Poor	Action			
Piping	1	Domestic Water (Hot &	DW	Not Insulated	099	Straight		A	Yes	0	(-)	0	(-)	0	(-)	NI	V 0000	None
Piping	1	Domestic Water (Hot &	DW	Not Insulated	099	Fitting		A	Yes	0	(-)	0	(-)	0	(-)	NI	V 0000	None
Duct	1	Not Found	N/F		NI			NI	No	0	(-)	0	(-)	0	(-)	NI	NI NI	None

Surveyor Notes:

**Legend:**

Access	Condition	Action	Sample Number
A - Accessible To All Building Occupants.	Good - No Visible damage or exposed material.	(-) No Action Required.	S #### Sample Collected.
B - Accessible To Maintenance Staff	Fair - Repairable Damage with minor amounts of exposed material.	(1) Immediate clean-up of debris or damaged ACM likely to be disturbed	V #### Material is visually identified to be identical to S ####.
	Poor - Irreparable damage with exposed & missing material.	(2) Type 2 precautions for entry into areas with ACM debris	V 0000 Material is visually identified to contain no asbestos.
C - Accessible To Maintenance Staff With a Ladder.	Note: Sprayed Materials are only rated as Good or Poor.	(3) ACM removal required	V 9000 Material is visually identified to contain asbestos.
		(4) Type 2 precautions for entry into areas where ACM is present	V 9500 Material is suspected to contain asbestos.
D - Not Accessible.		(5) Proactive ACM removal	Note: Vinyl Tiles, Vinyl sheet Flooring, Drywall, Plaster and Textured Finish (Coat) are considered suspect materials if not sampled.
		(6) Proactive ACM repair	
		(7) Management program and surveillance	
		(8) Suspect Material	

Units : SF - Square Feet LF - Linear Feet EA - Each % - Percentage

**APPENDIX III**  
**DRAWINGS OUTLINING INSPECTION LOCATIONS**

XX LOCATION NUMBERS AS NOTED  
DURING SURVEY BY PINCHIN ENVIRONMENTAL

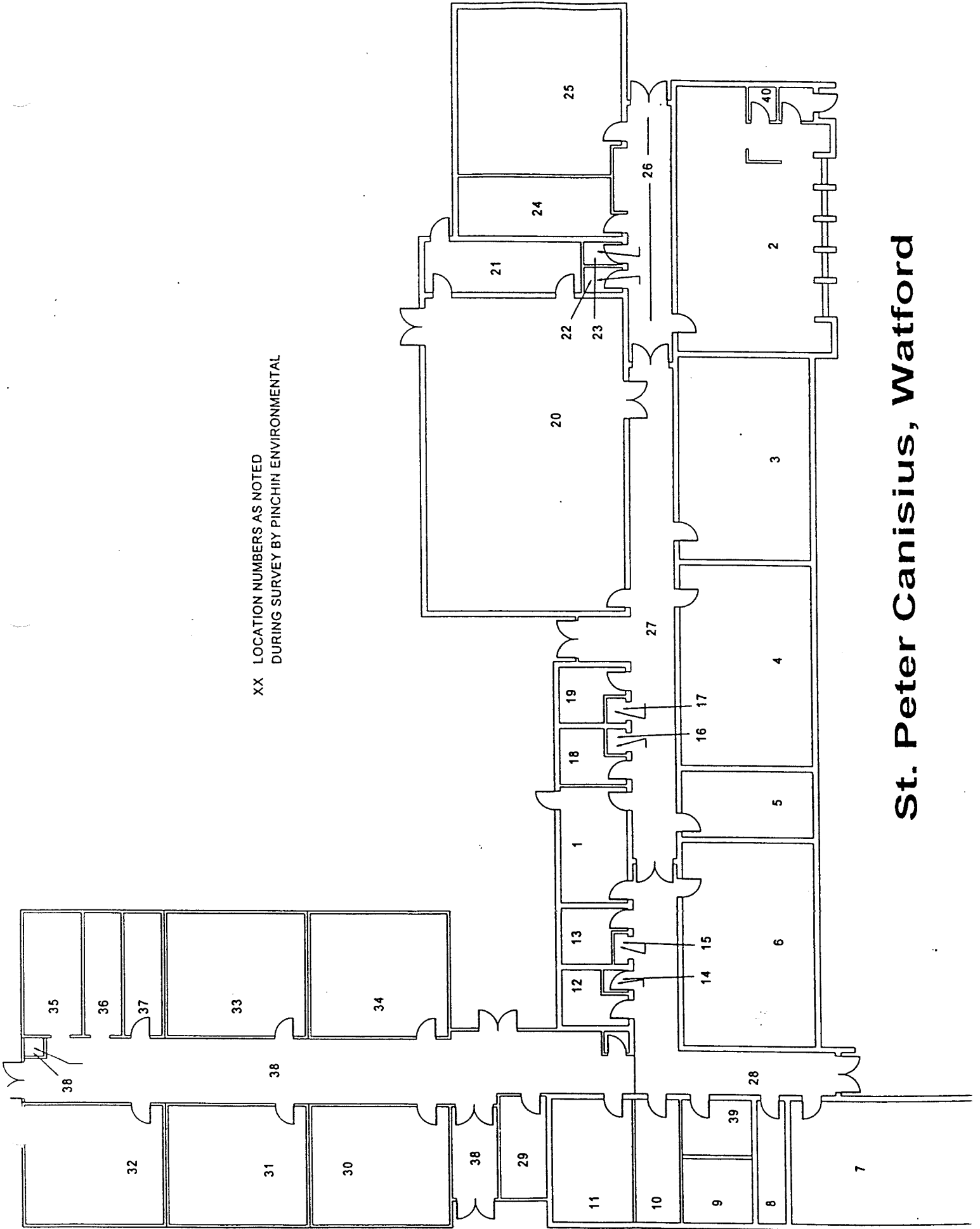

# St. Peter Canisius, Watford